

# Assembly

## S - Swing Module Start

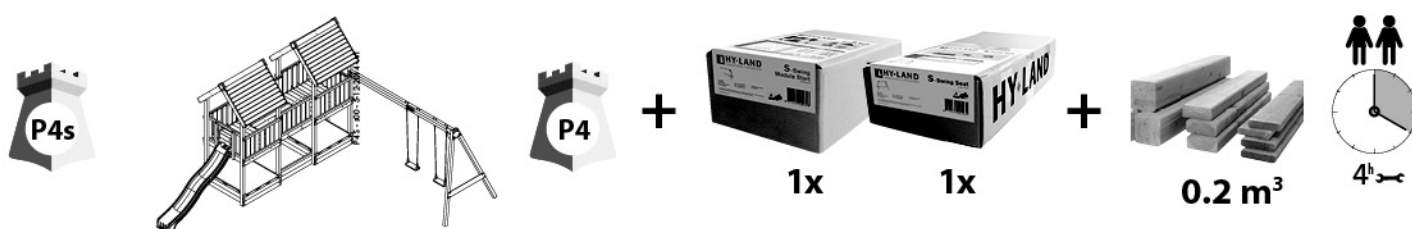

# Assembly steps

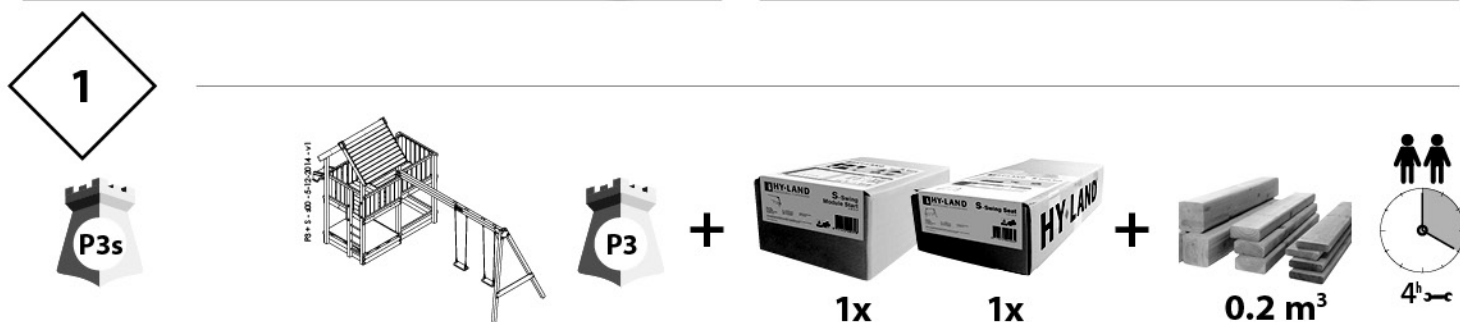
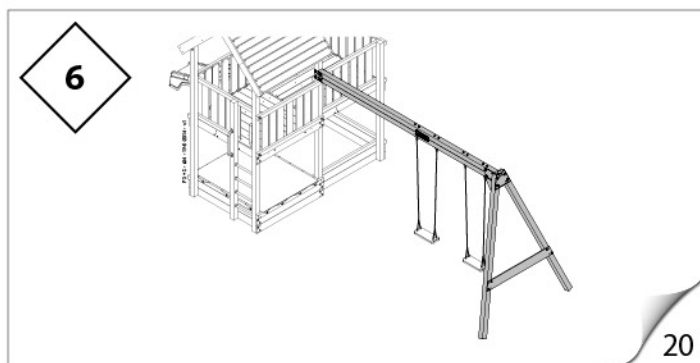
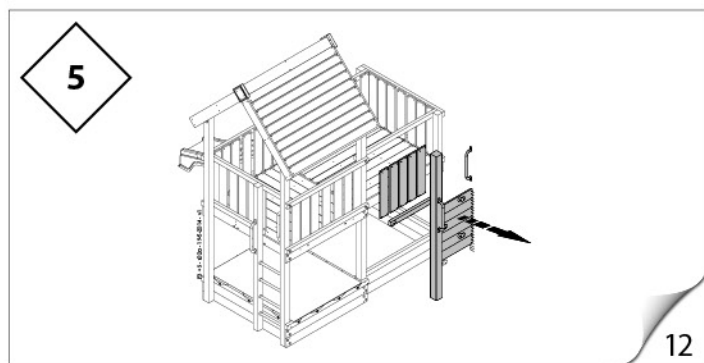
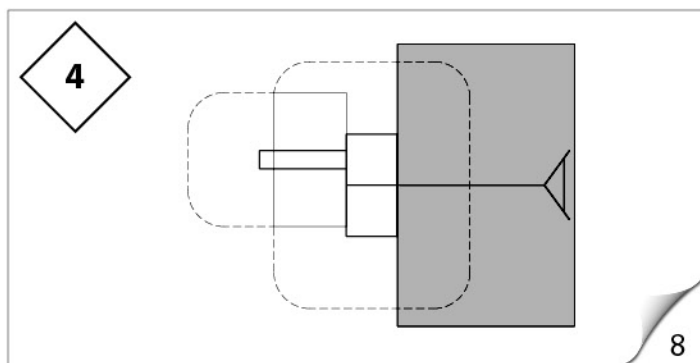
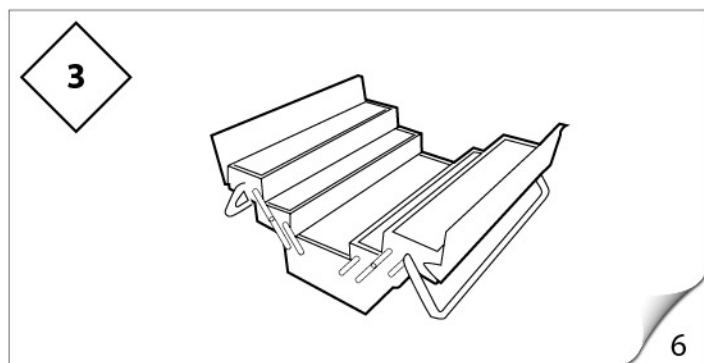

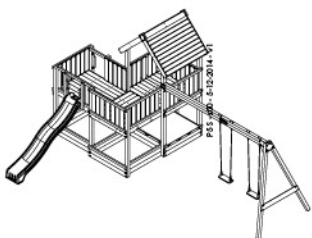

1x

1x



0.2 m<sup>3</sup>

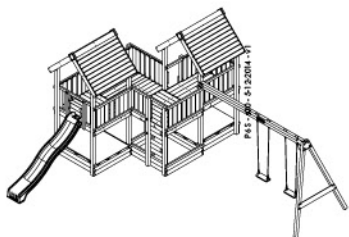

1x

1x



0.2 m<sup>3</sup>

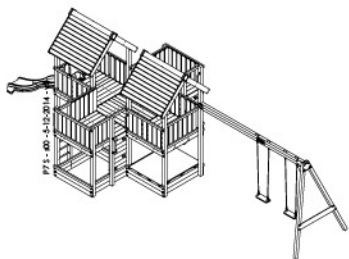

1x

1x



0.2 m<sup>3</sup>

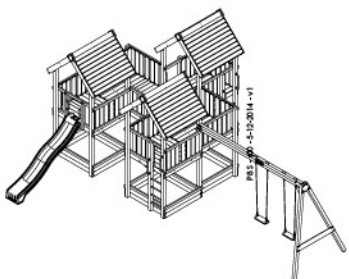

1x

1x



0.2 m<sup>3</sup>

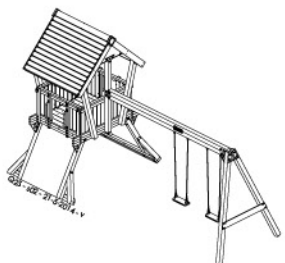

1x

1x



0.2 m<sup>3</sup>

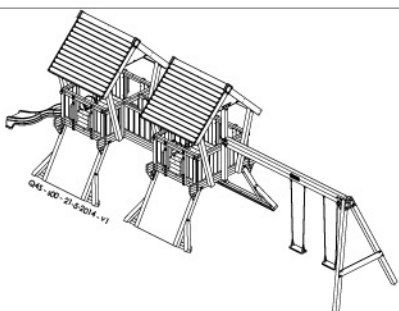

1x

1x



0.2 m<sup>3</sup>



2.1a

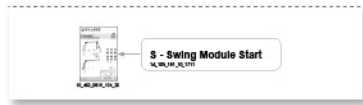

10\_467\_3020\_105\_26

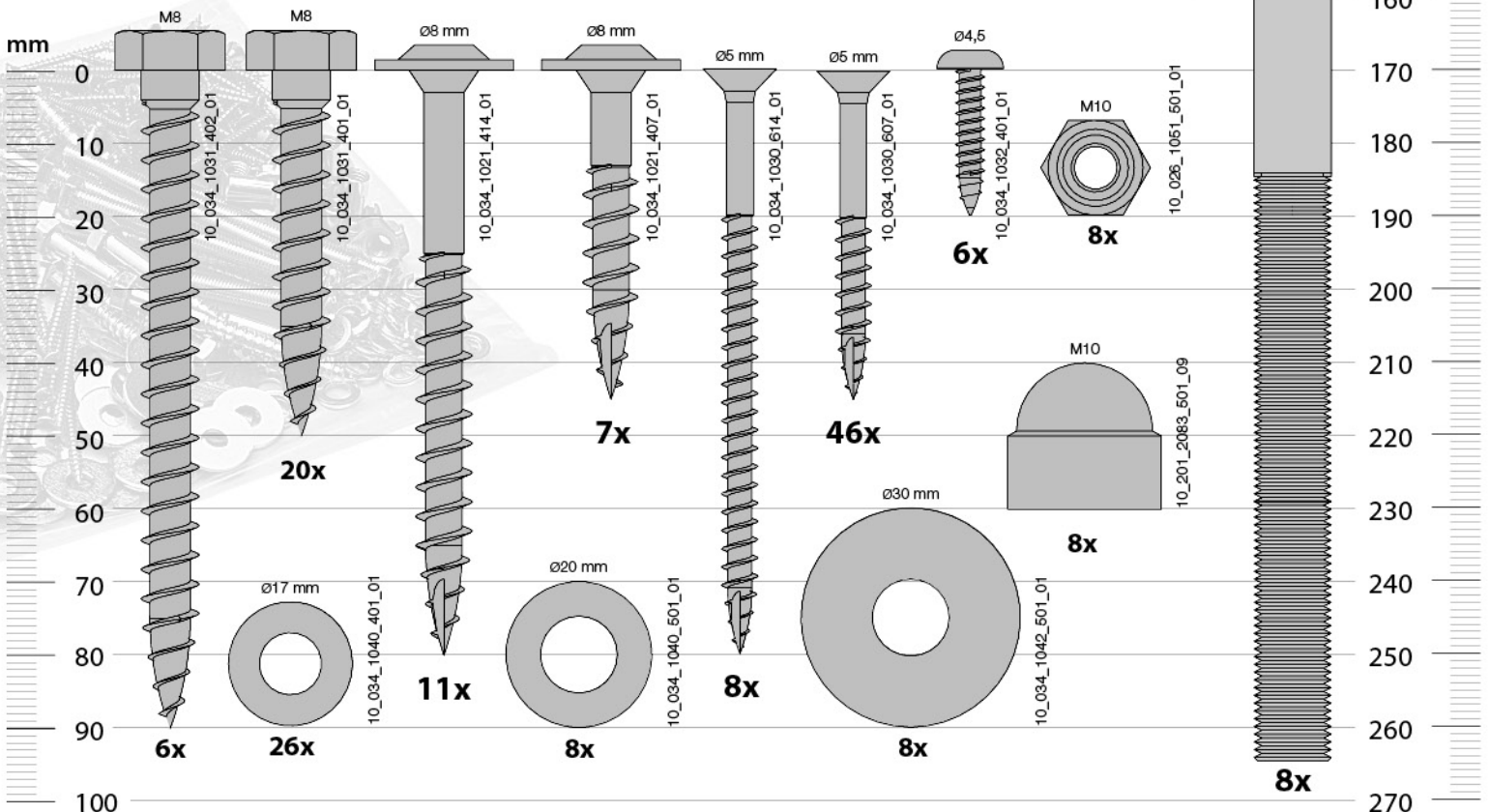
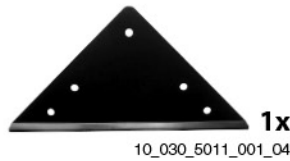

2.1b



2.2

## Timber

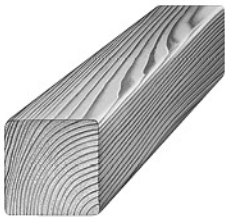

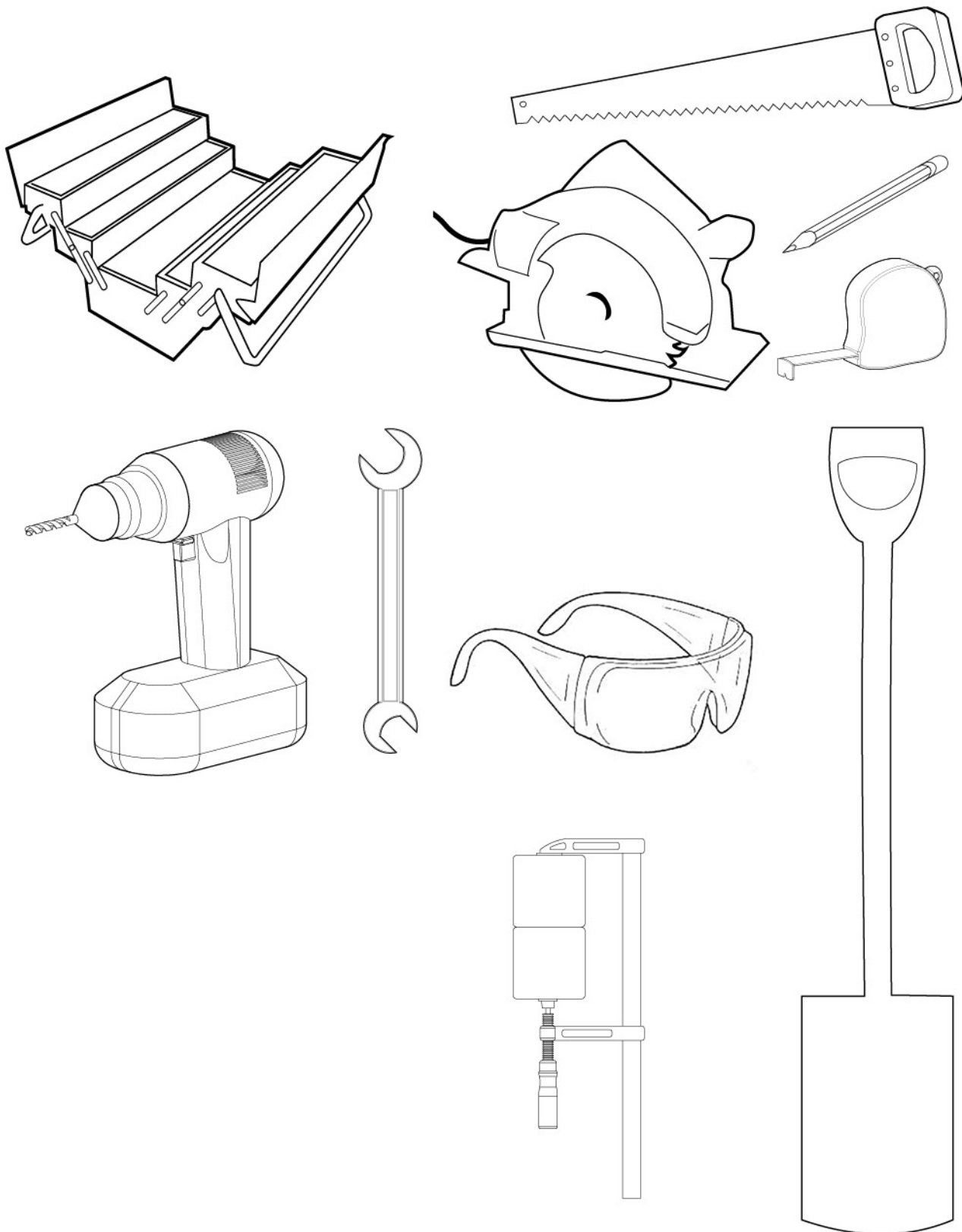

# 3.2

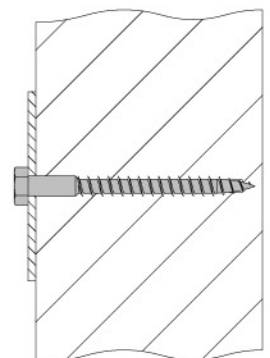
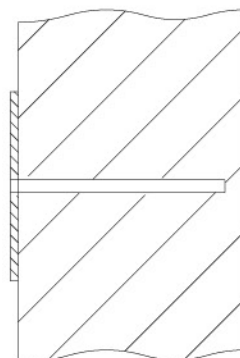
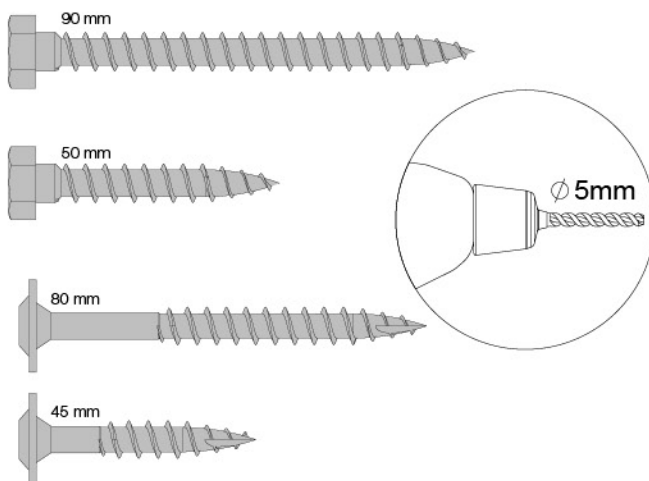
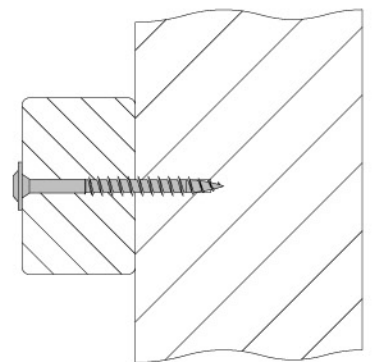
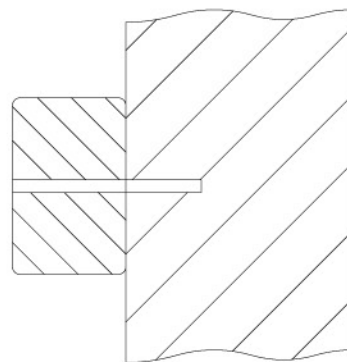
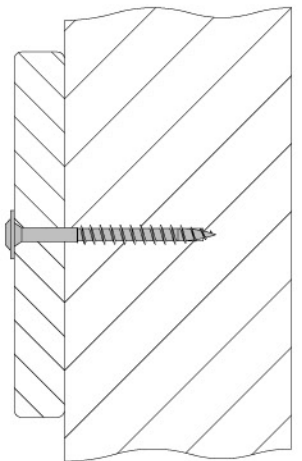
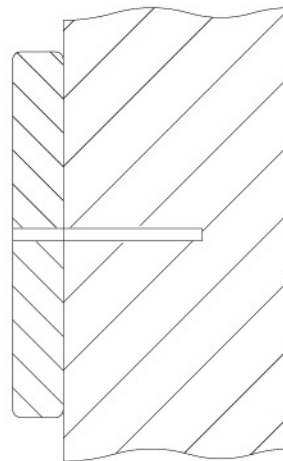
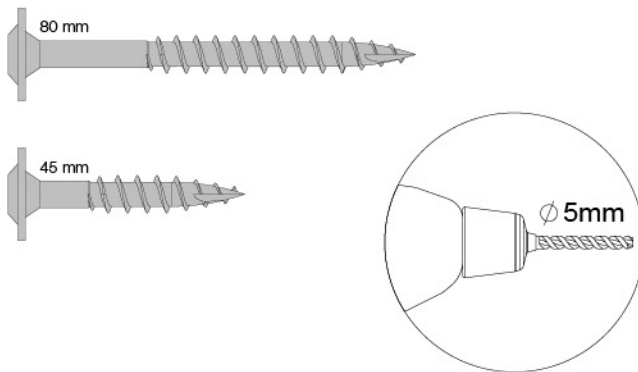
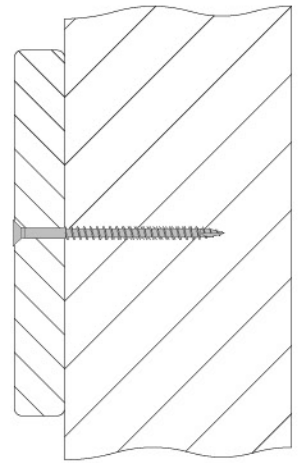
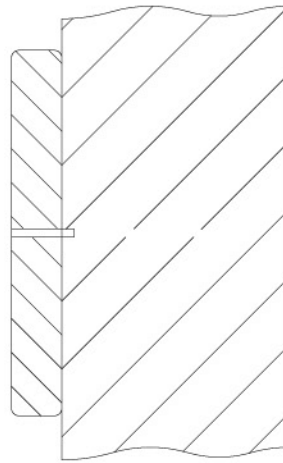
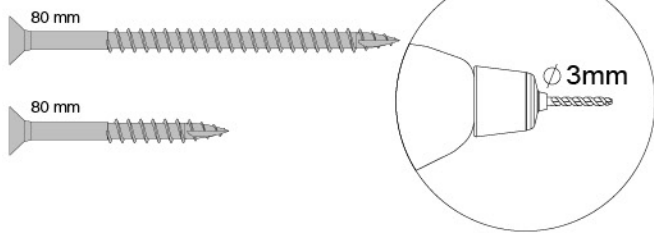

4.1a

P3s

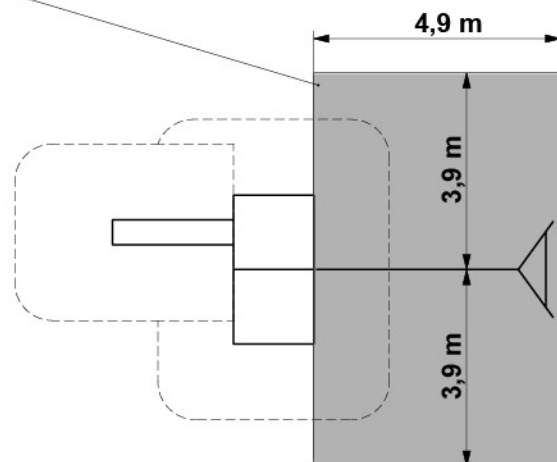
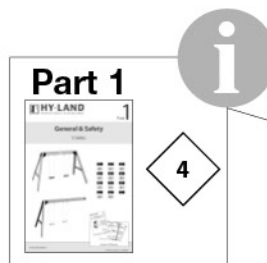
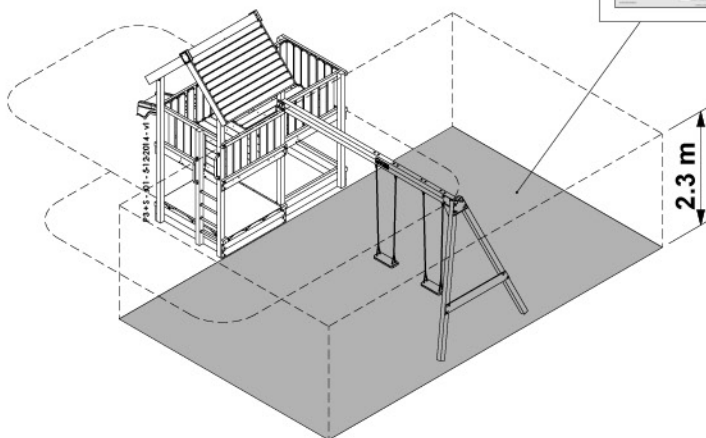

P4s

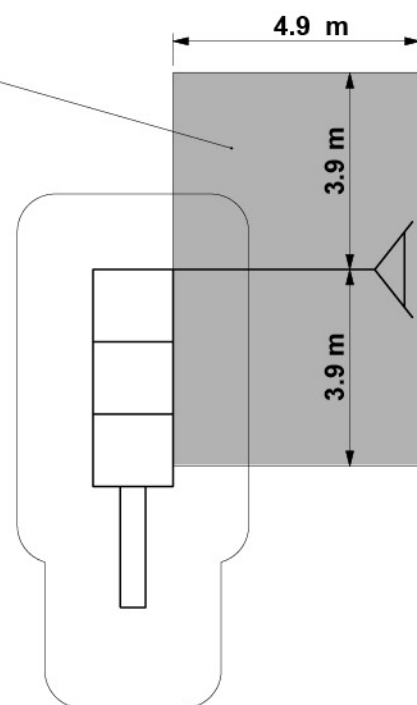
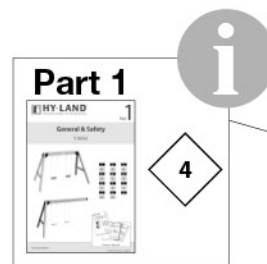
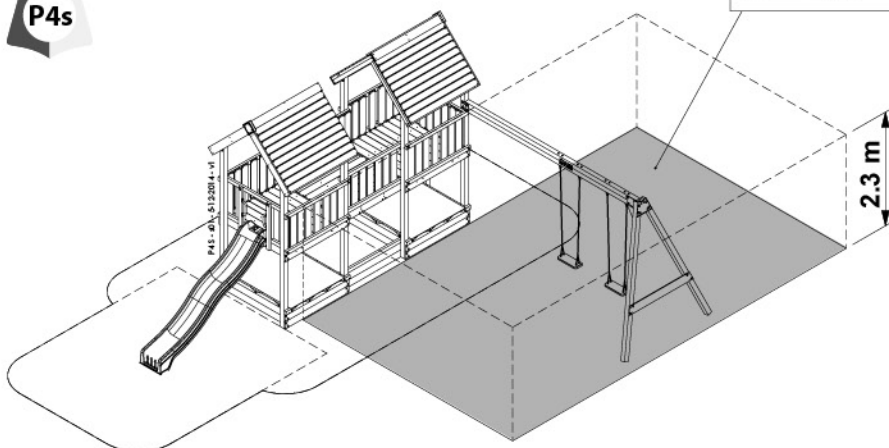

P5s

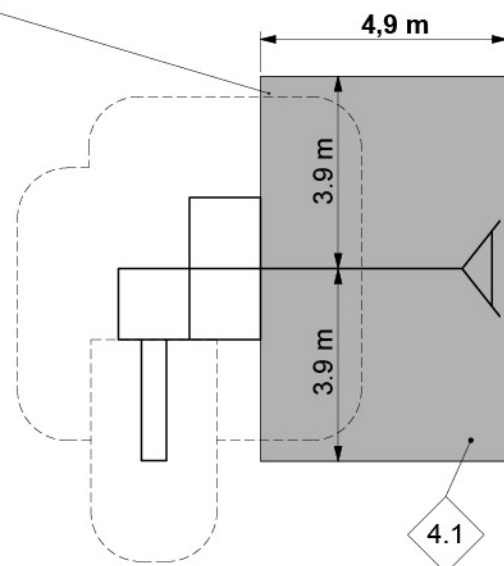
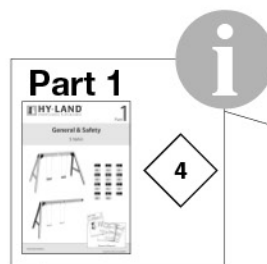
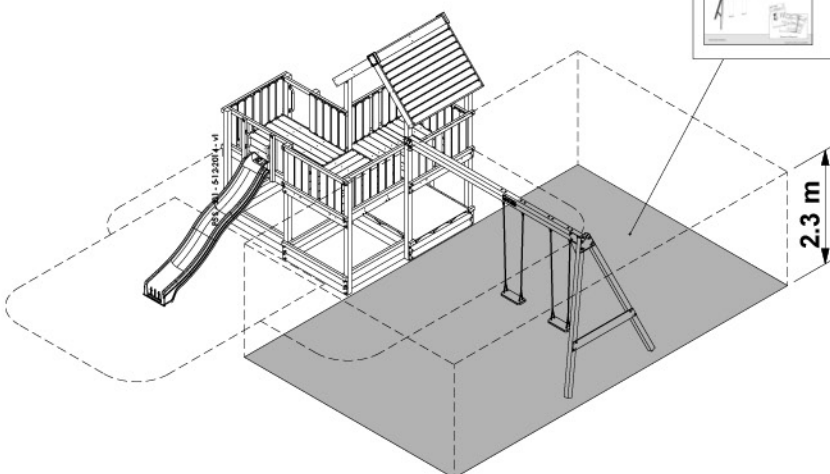



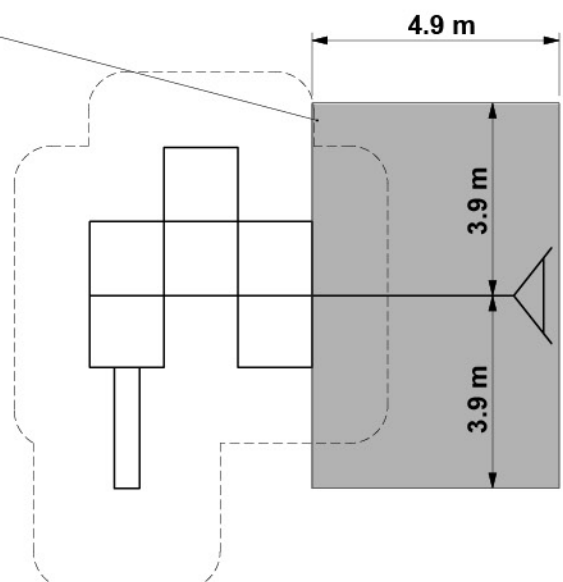
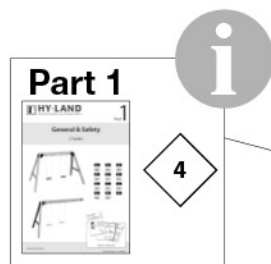
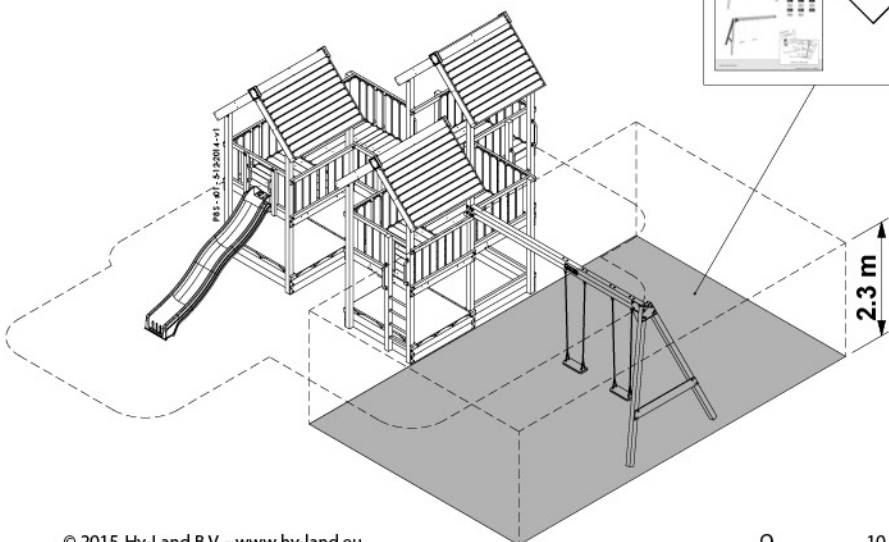
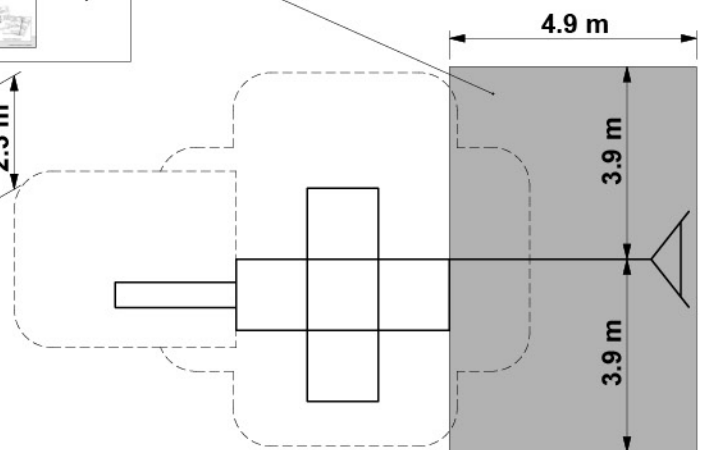
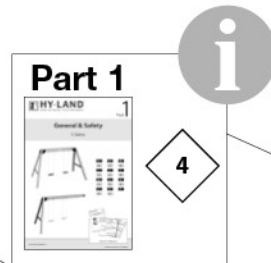
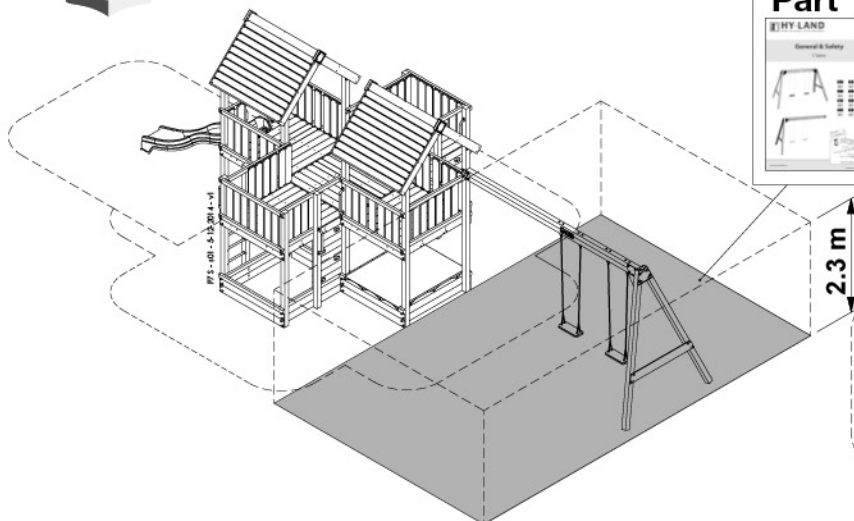
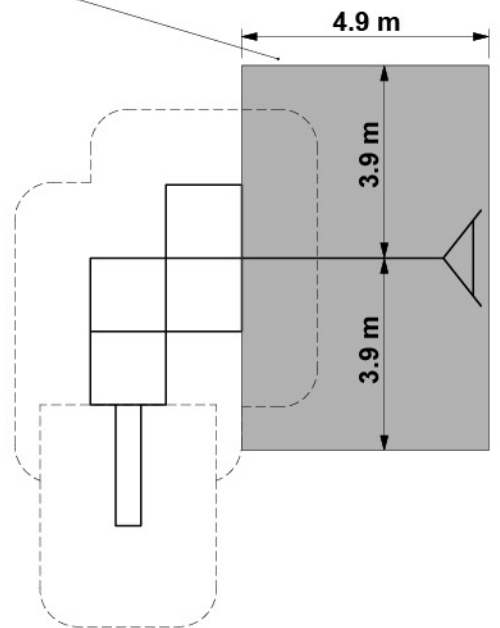
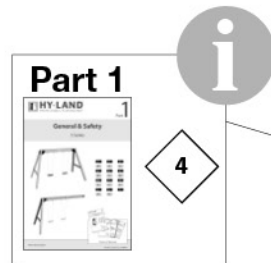
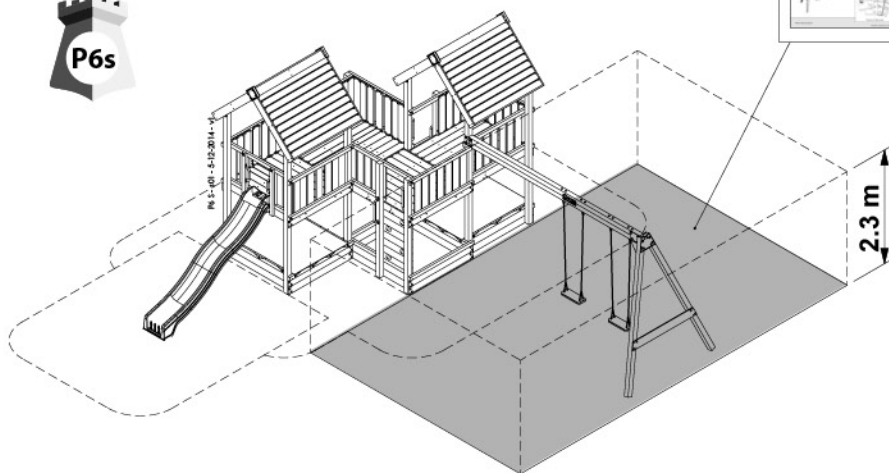

4.1b

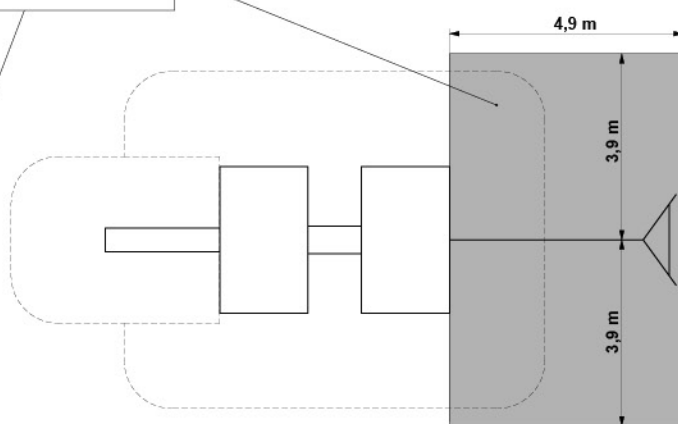
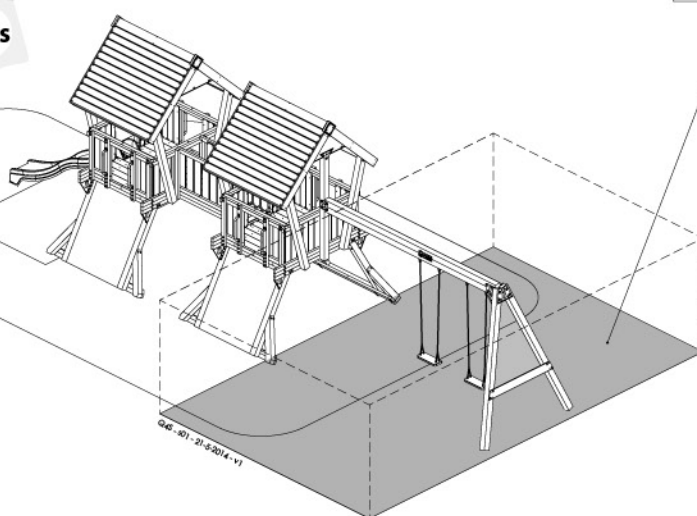
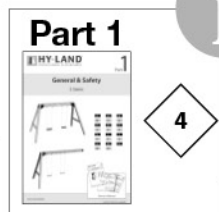
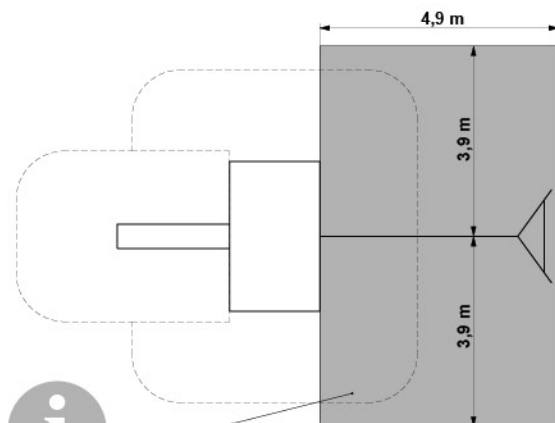
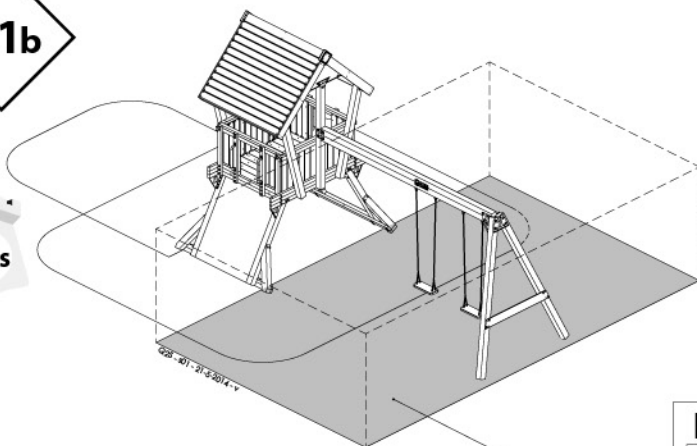

4.2

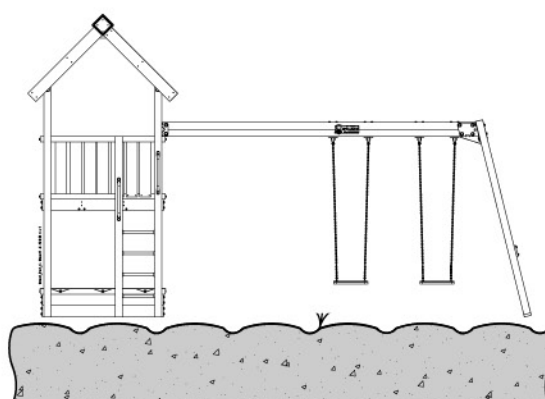
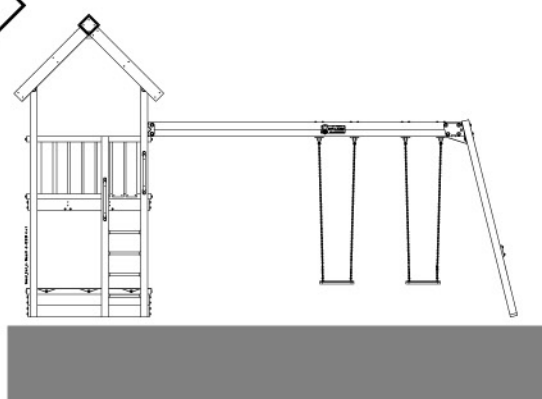

4.3



4.4

4.3

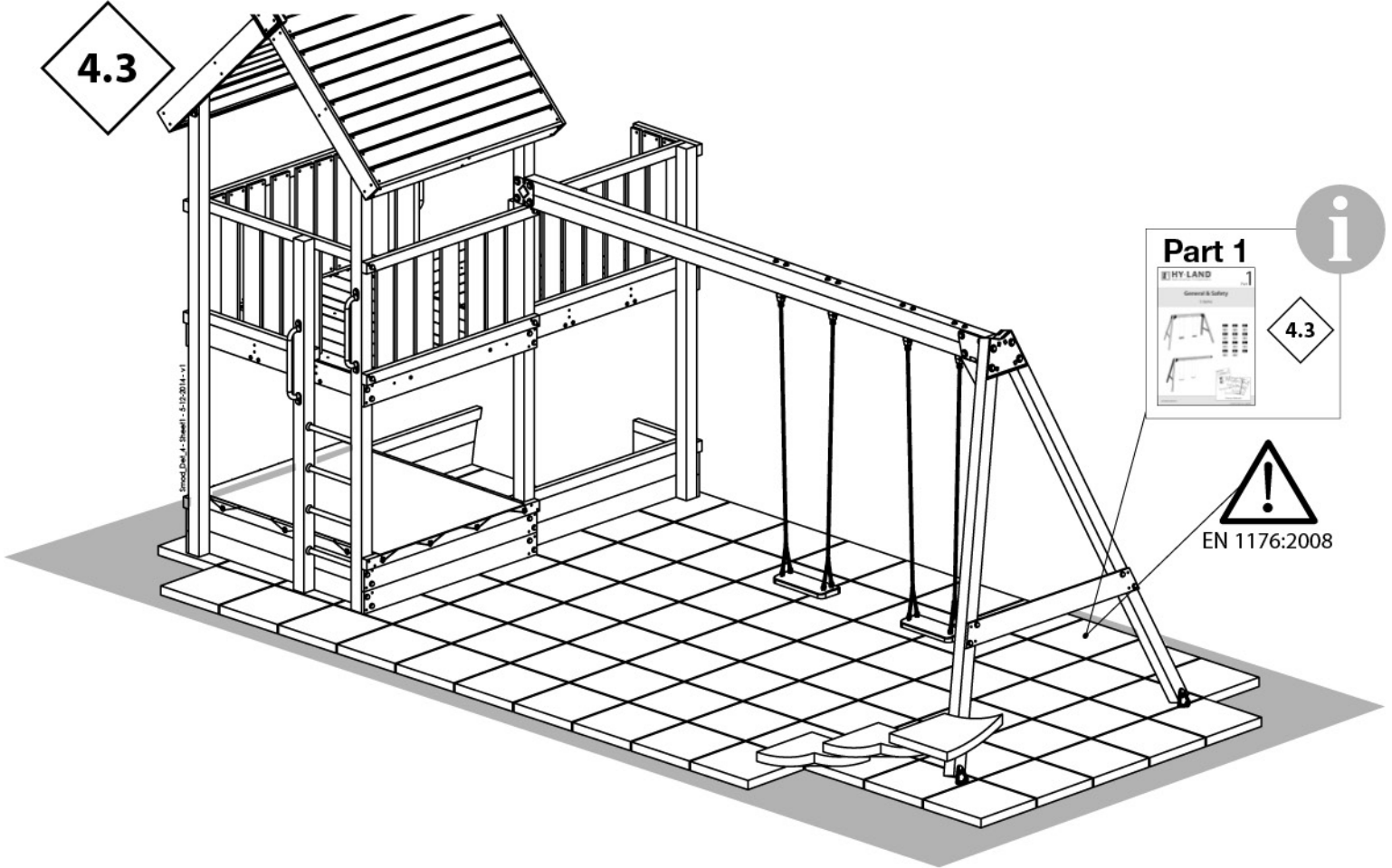

4.4

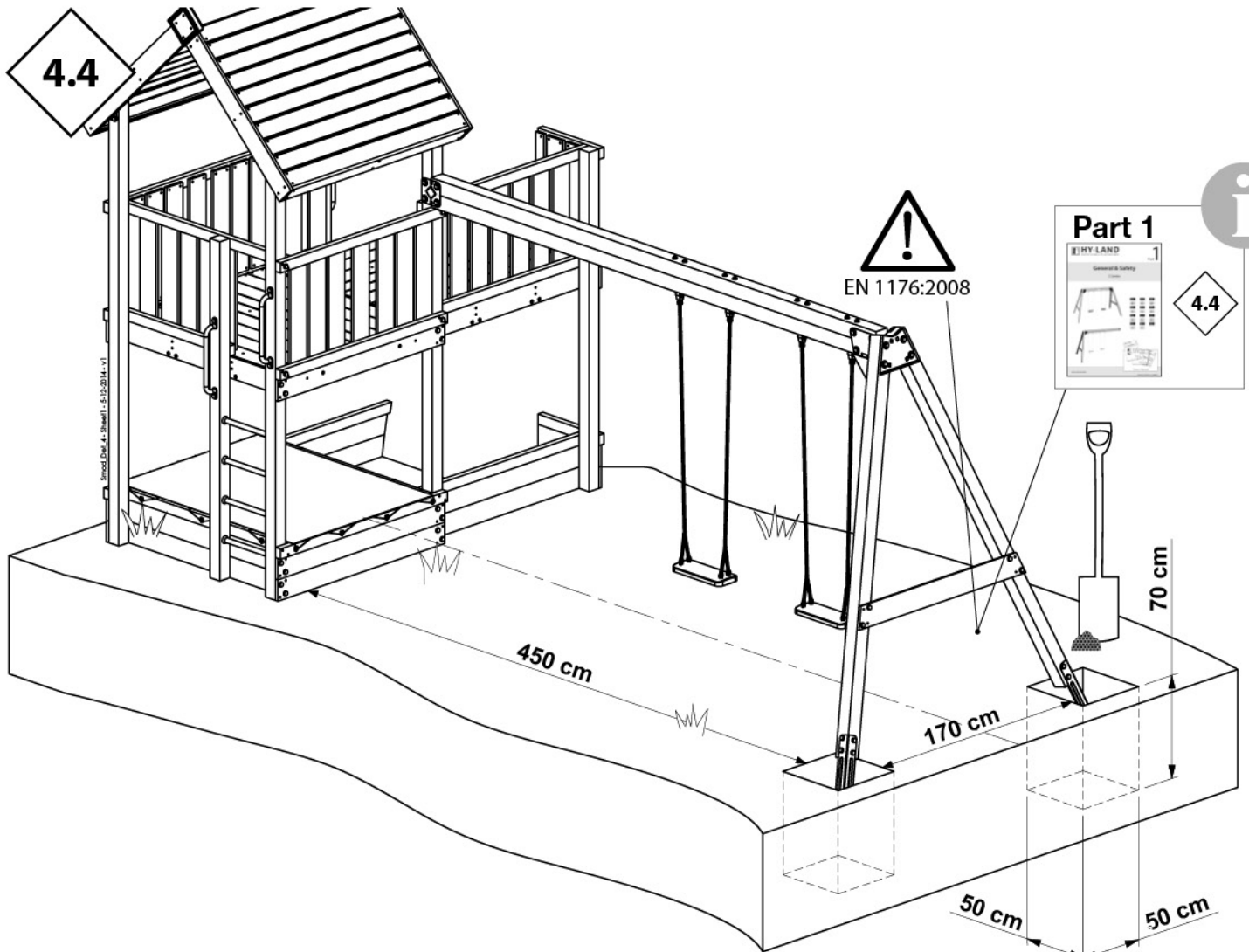

5

P3s

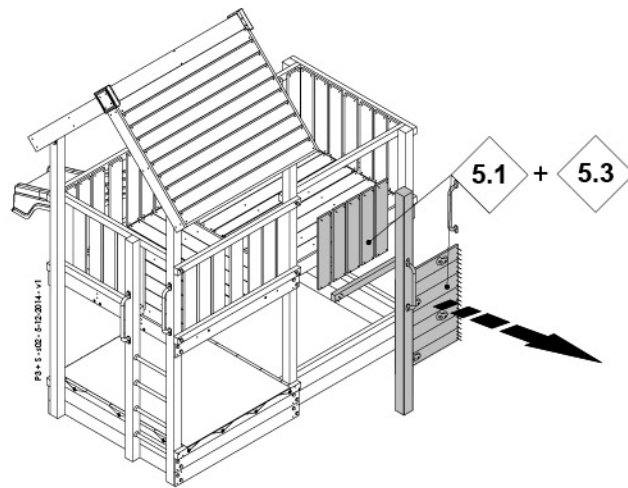

P4s

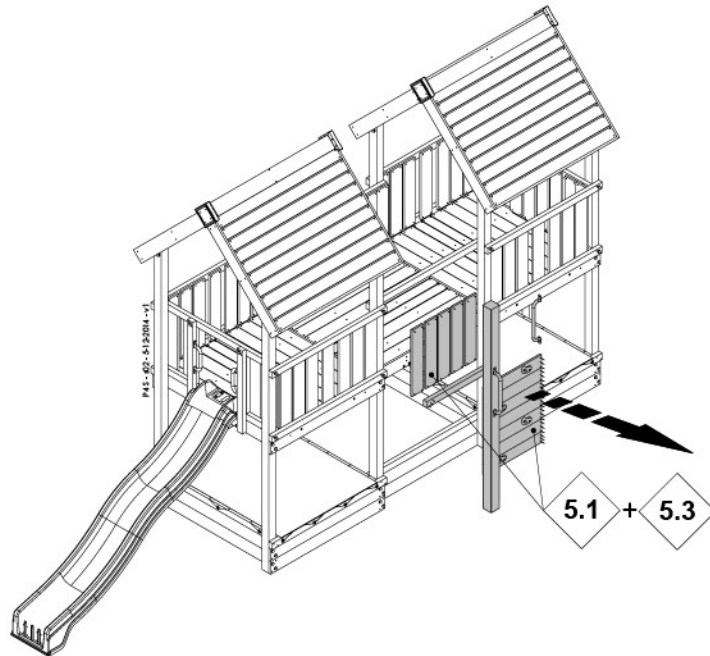

P5s

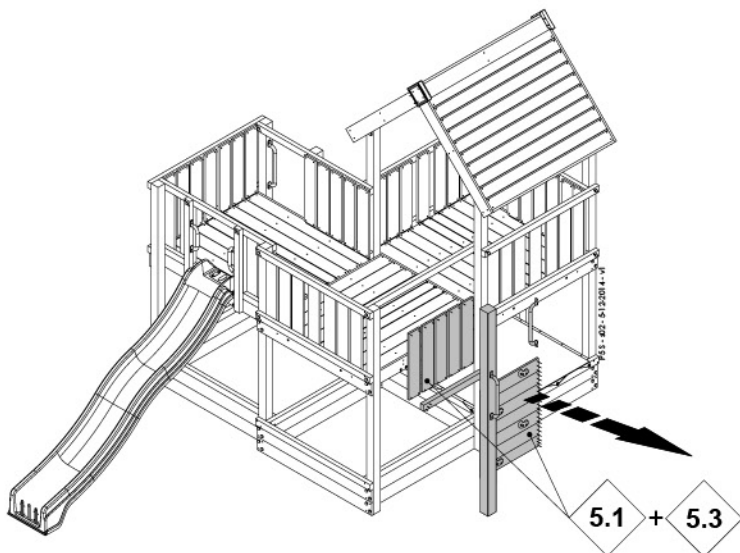

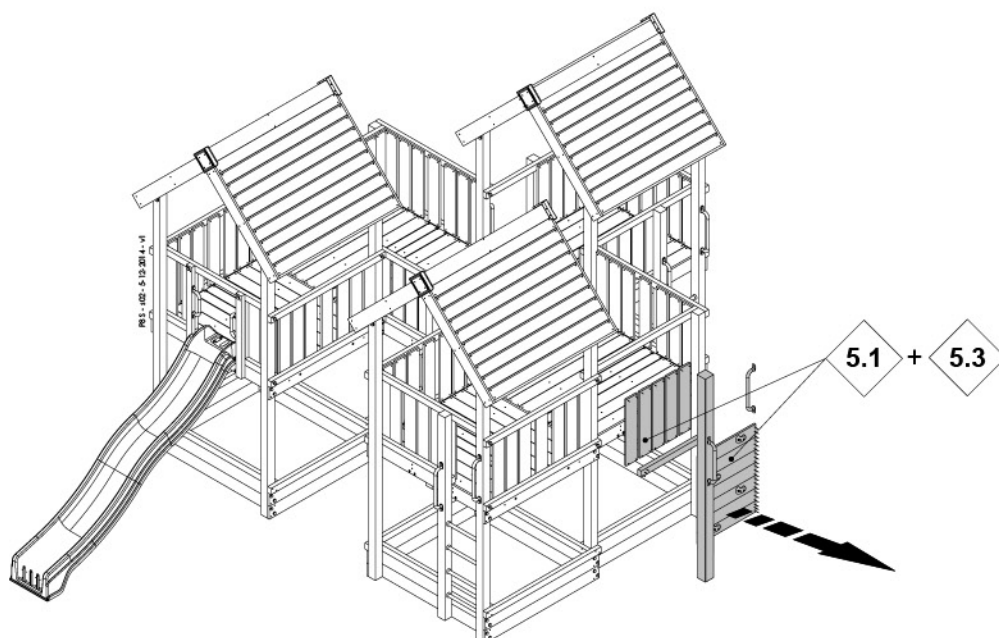
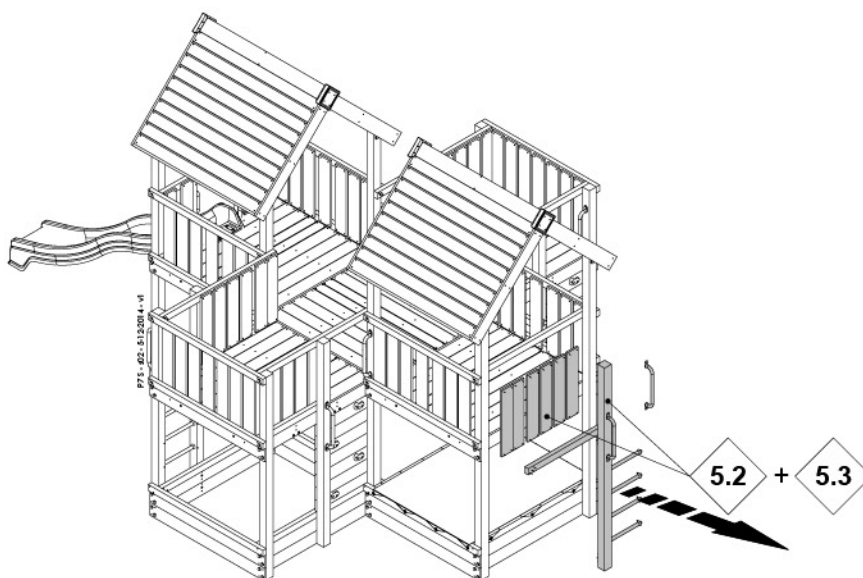
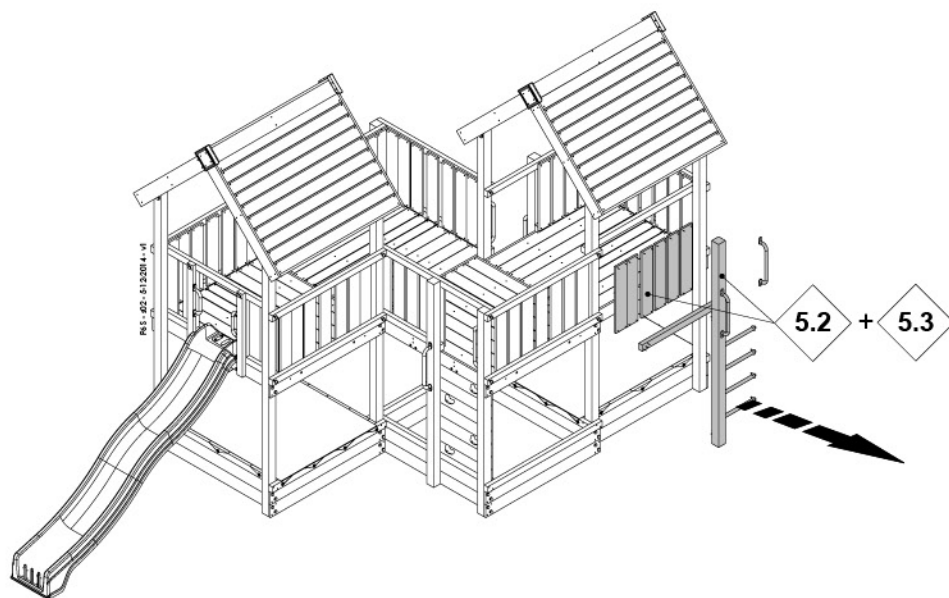

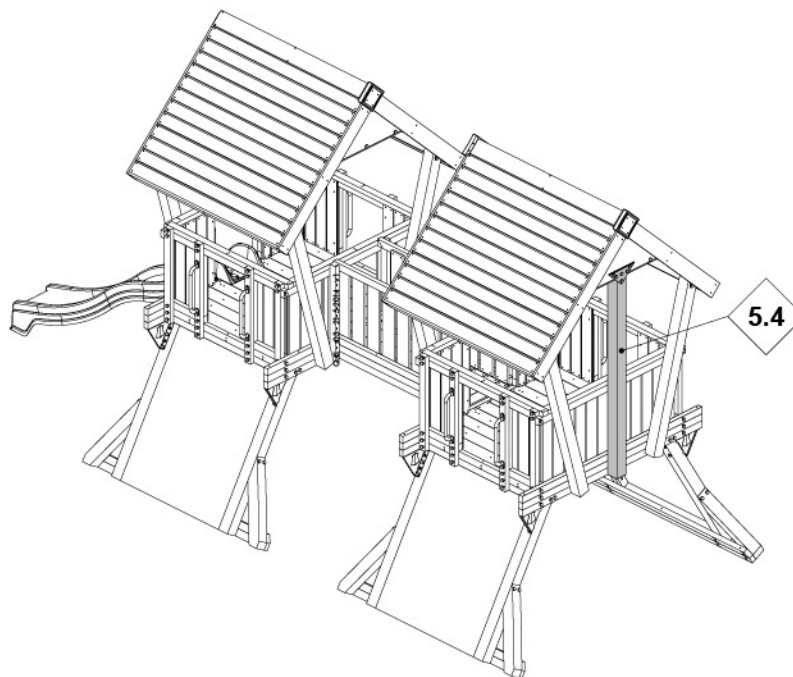
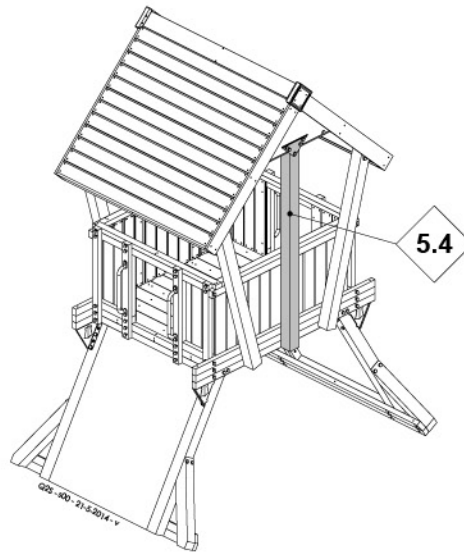

5.1

K (5x)

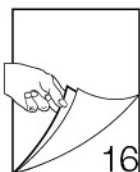

5.3b

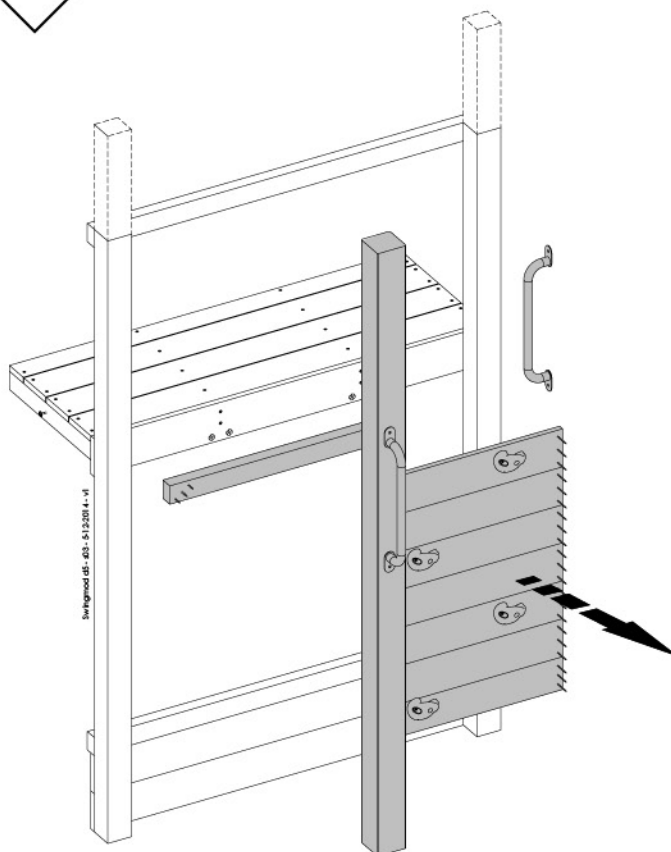
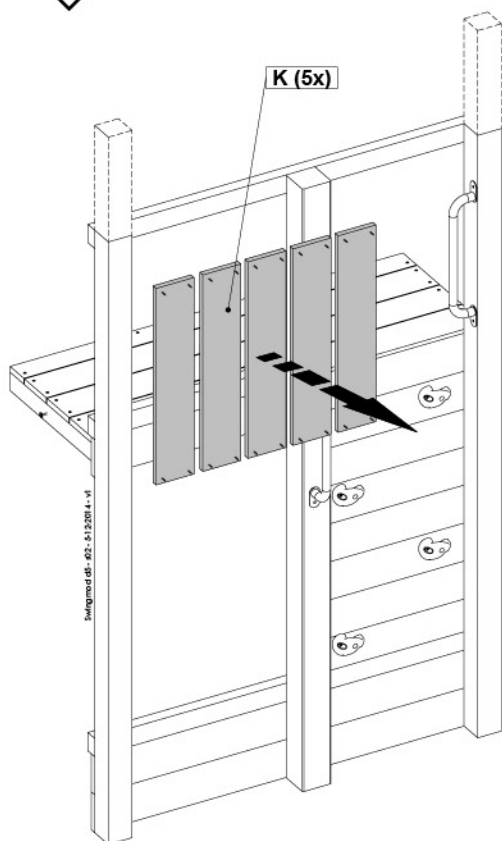

5.2

4x

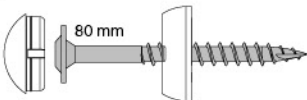

K (6x)

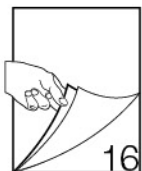

5.3b

A

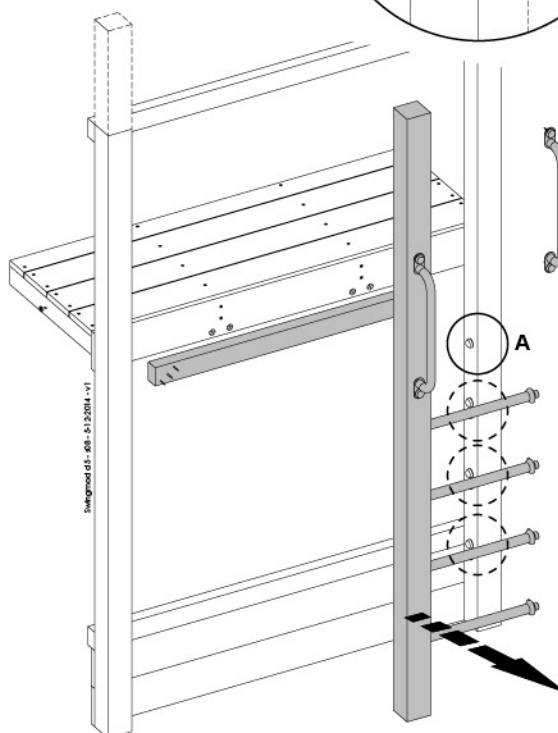
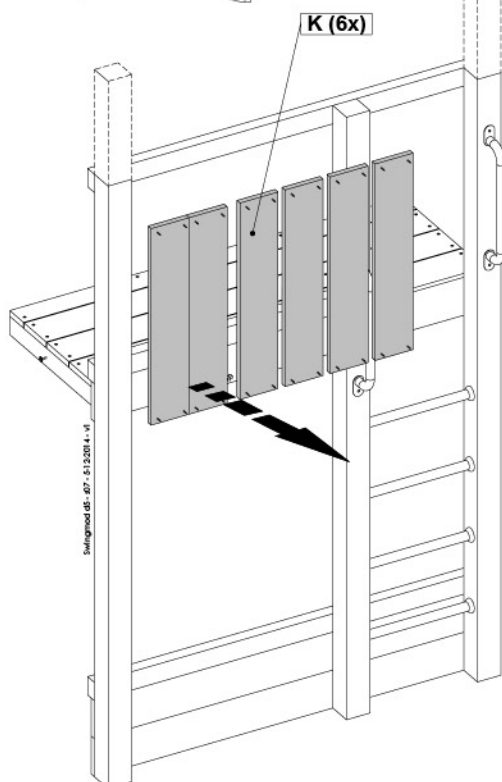
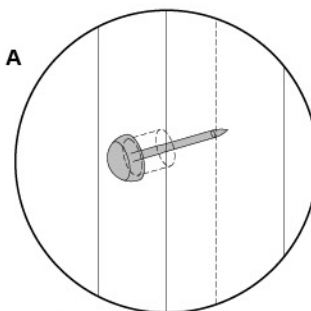

# 5.3a

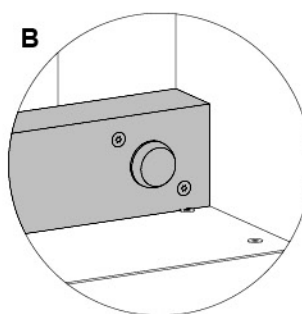
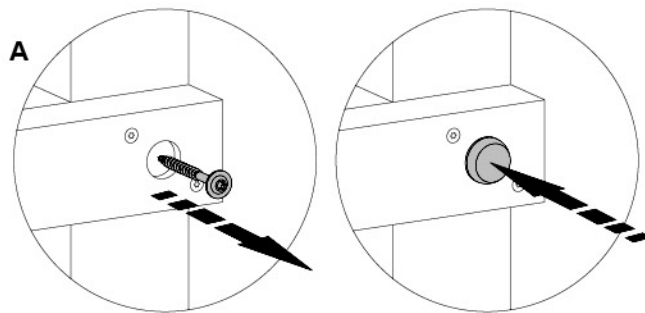
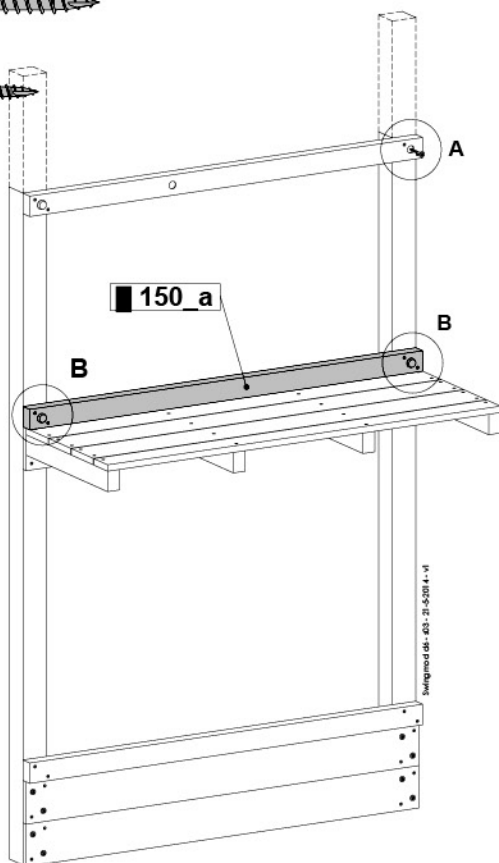
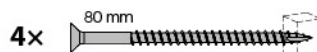
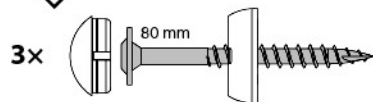

# 5.3b

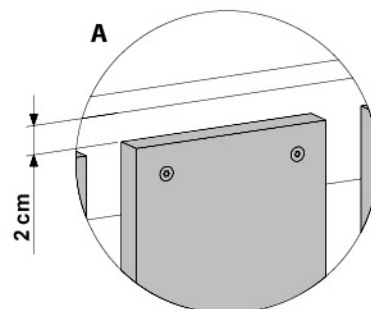
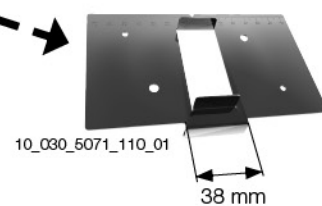
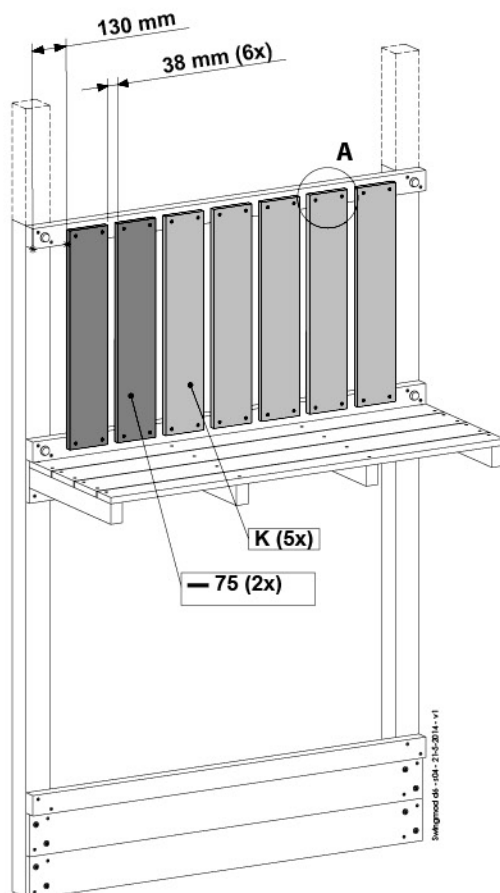



5.4a

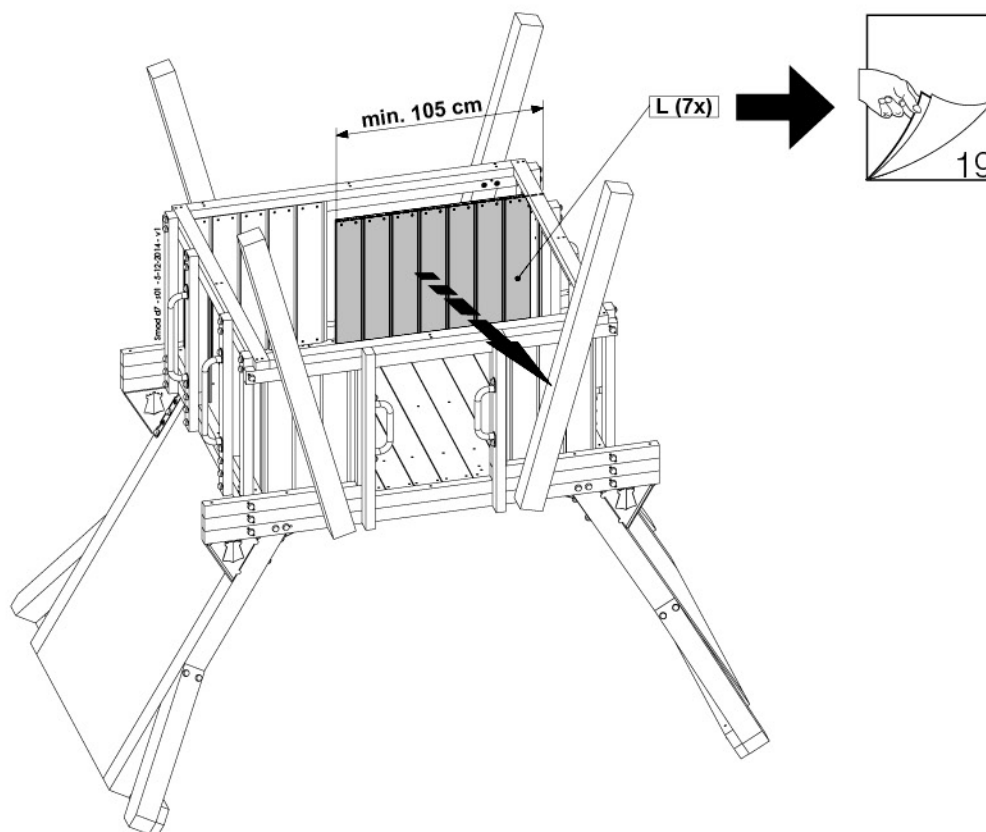

5.4e

5.4b

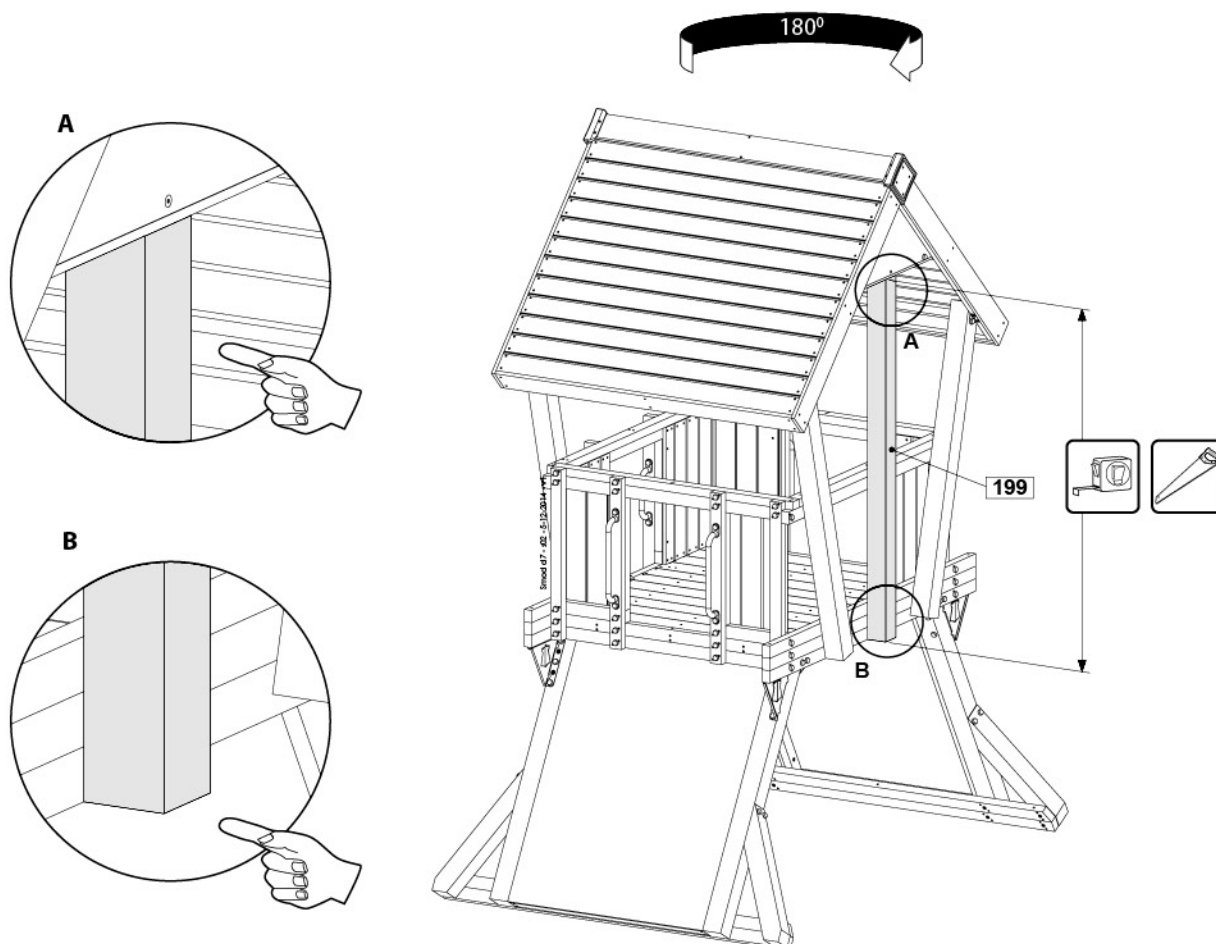

# 5.4c

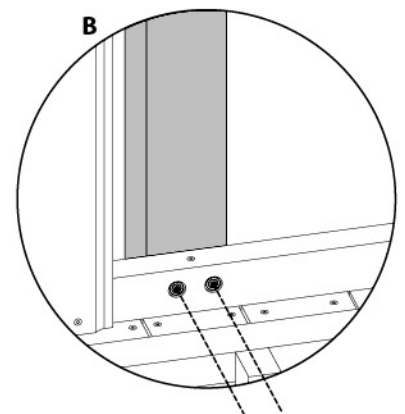
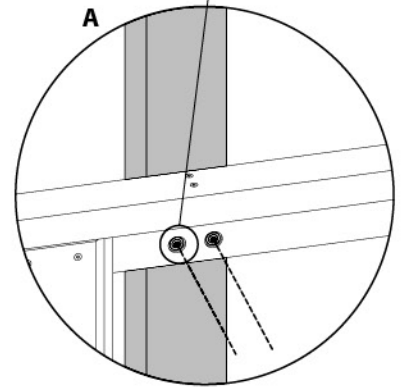
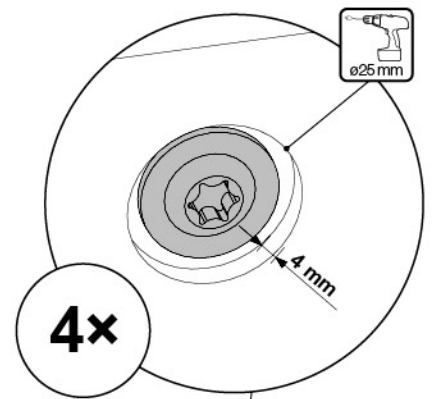
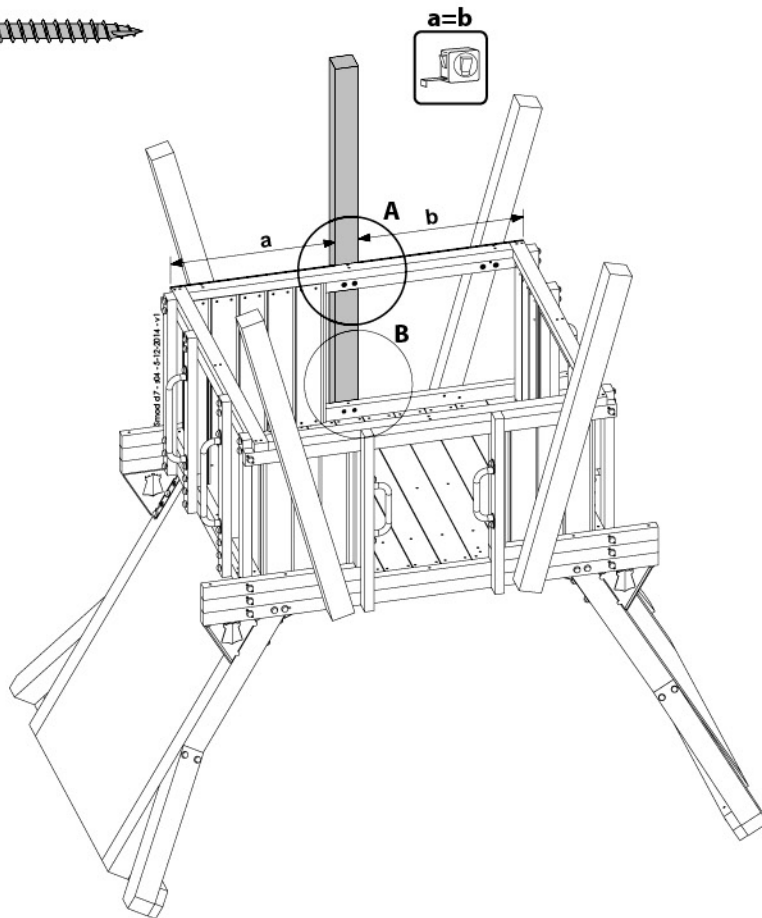
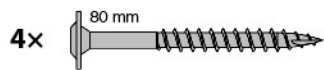

# 5.4d

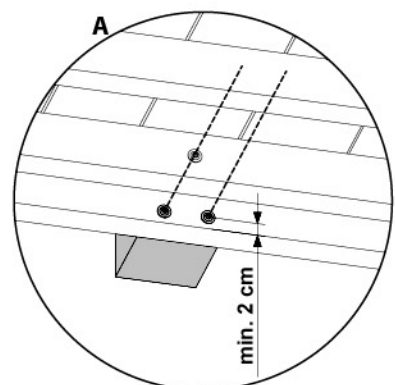
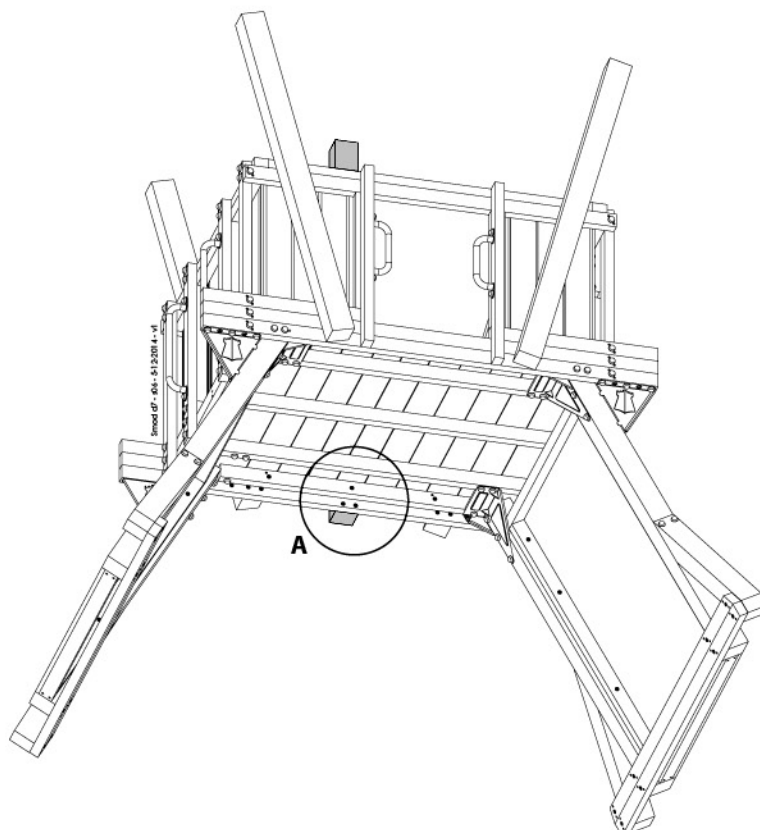
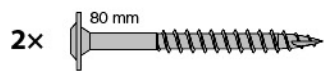

**5.4e**

36 - 44x

45 mm

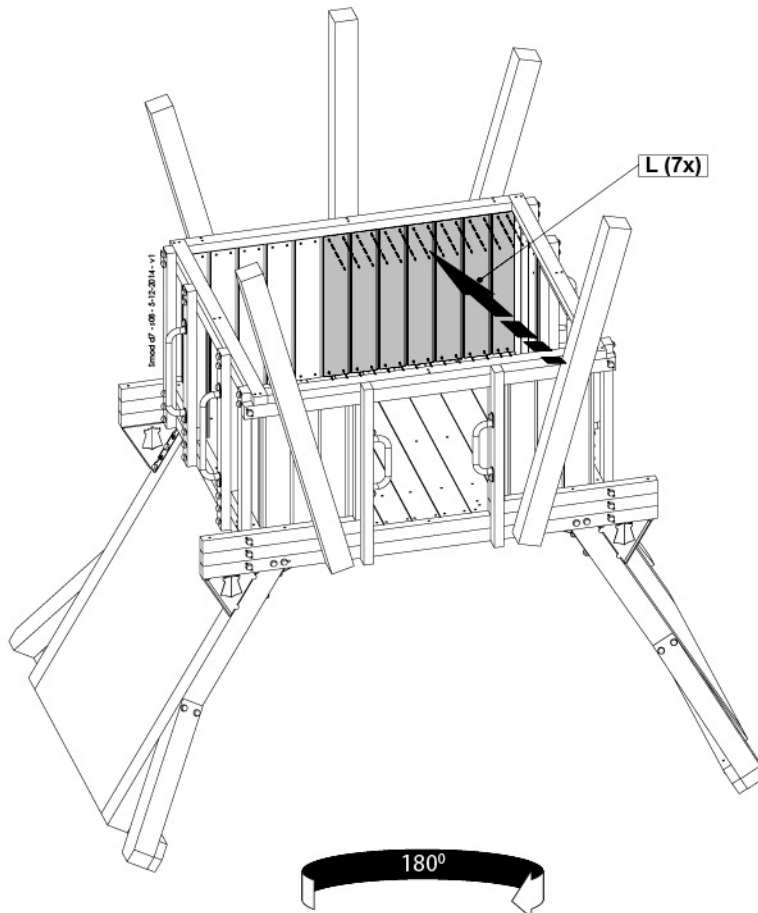
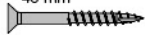

**5.4f**

5x

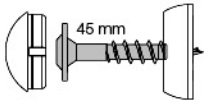

1x



10\_030\_5011\_001\_04

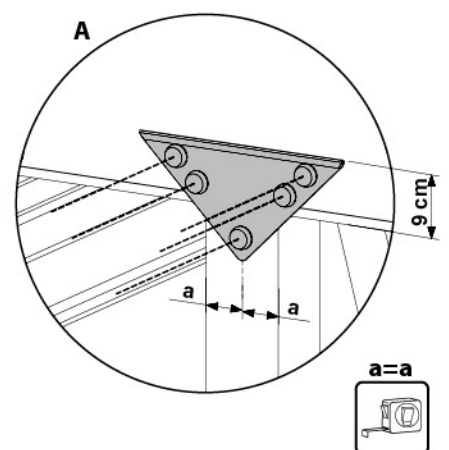
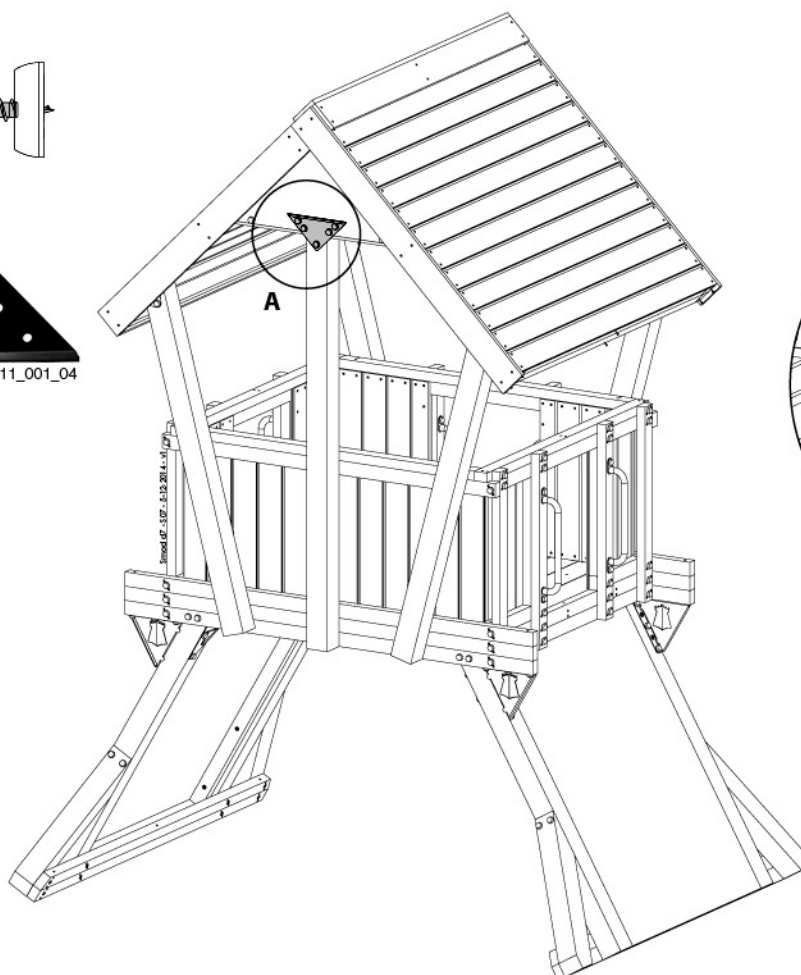

6

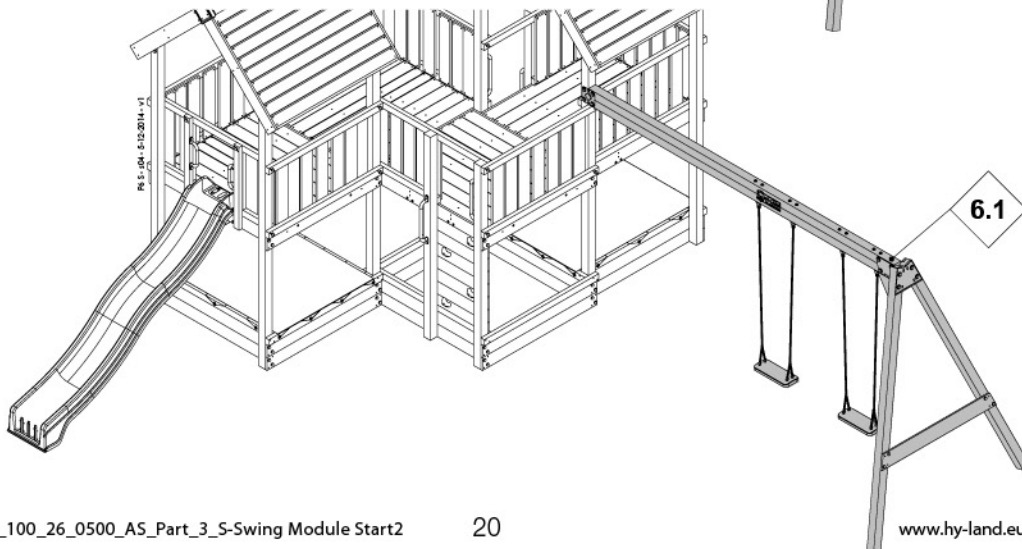
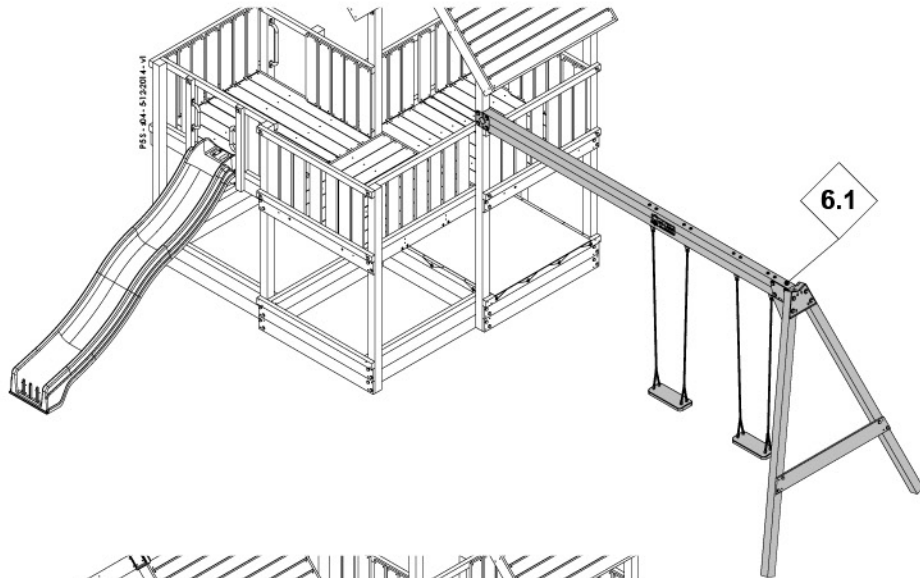
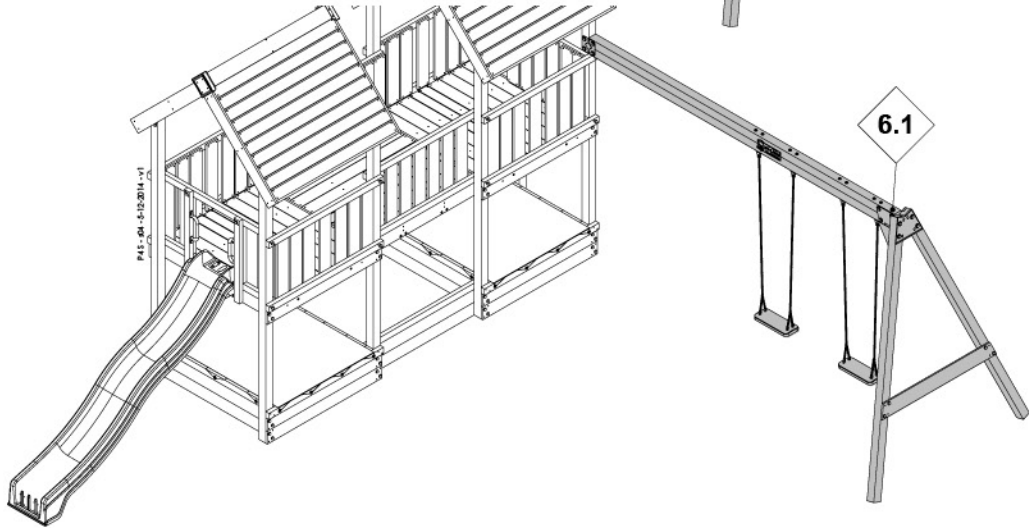
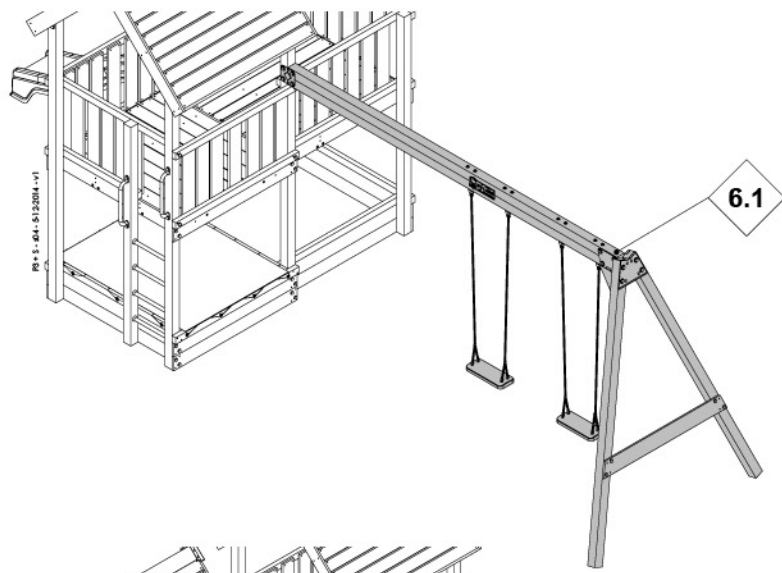

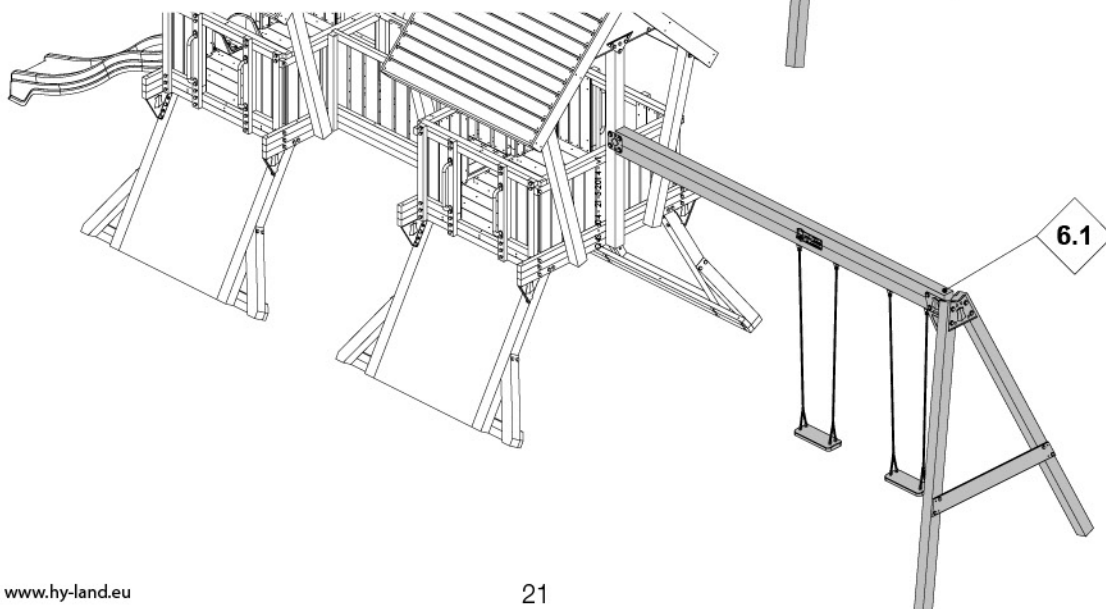
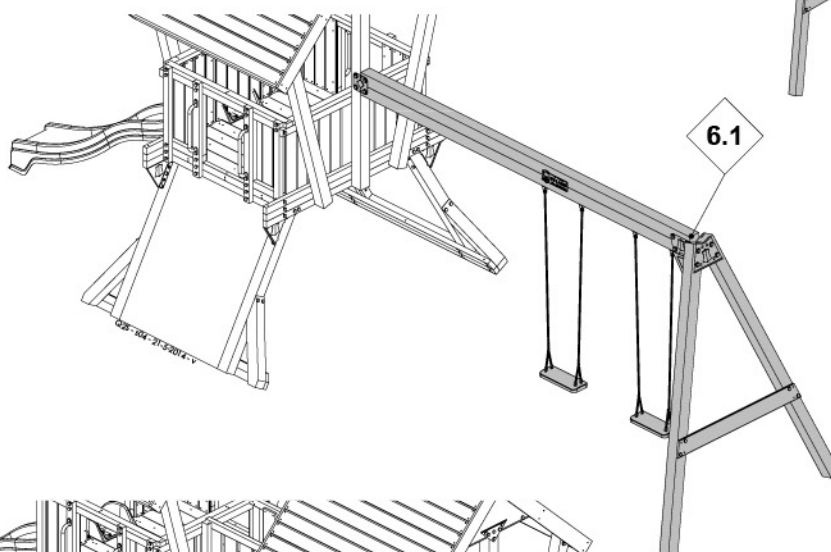
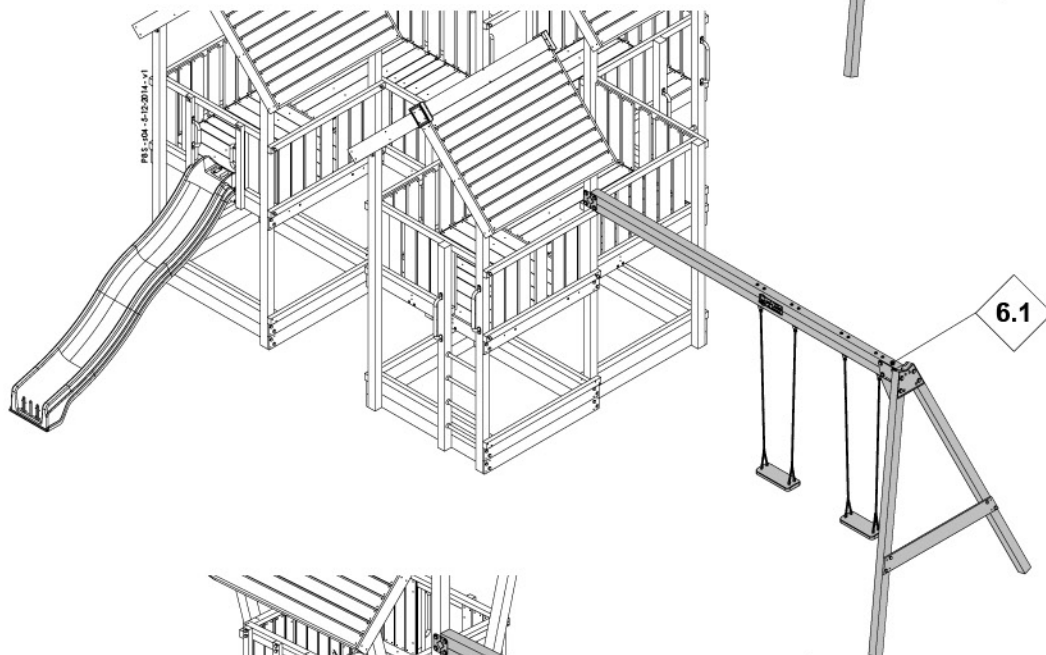
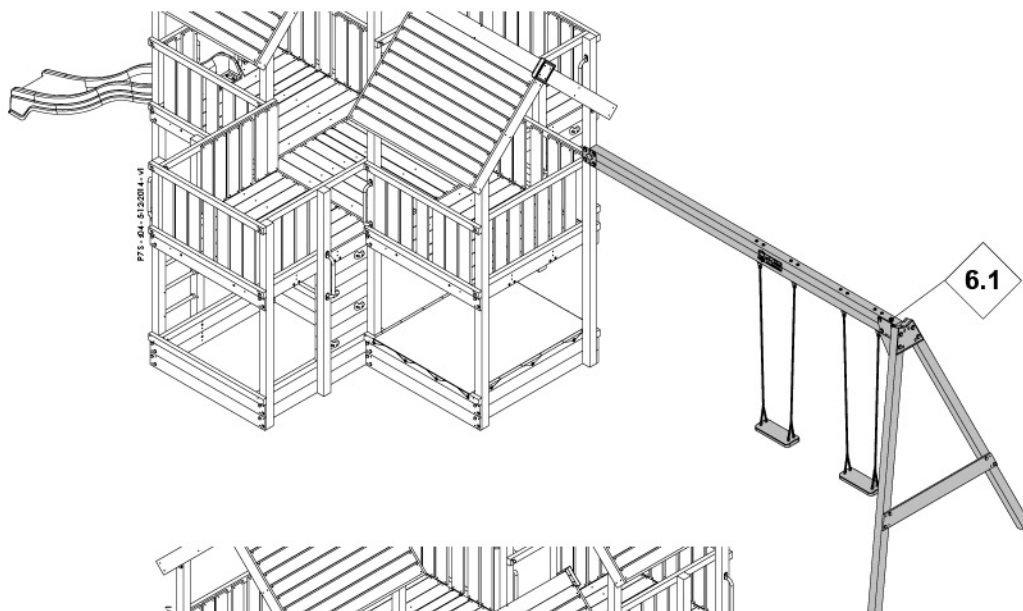

**6.1a**

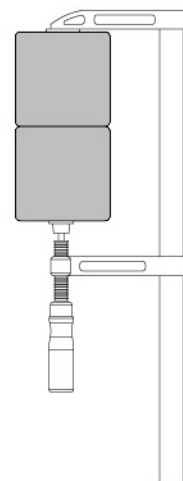

**6.1b**

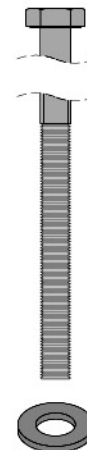

# 6.1c

8x M10

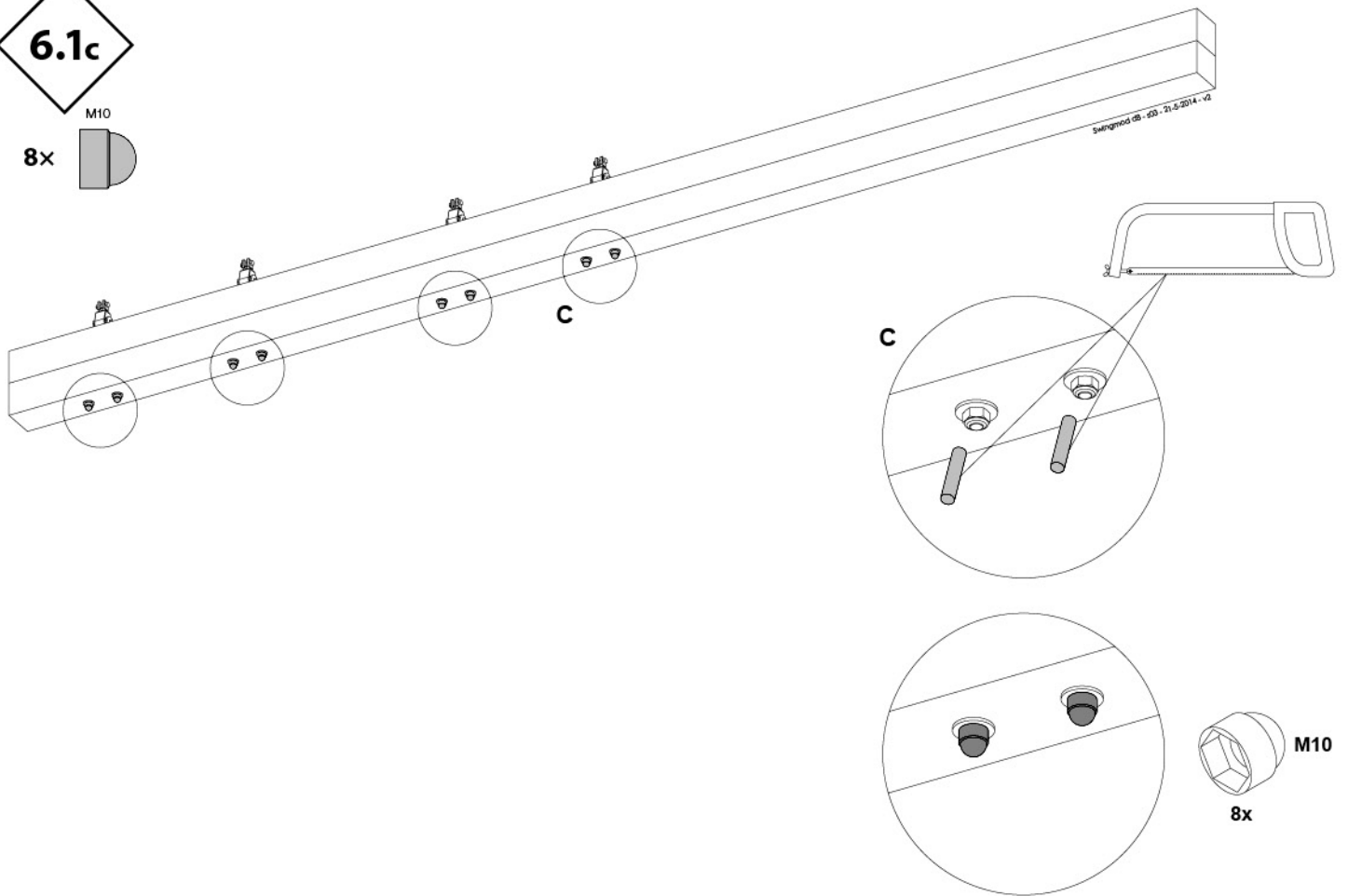

# 6.1d

8x 50 mm Ø17 mm

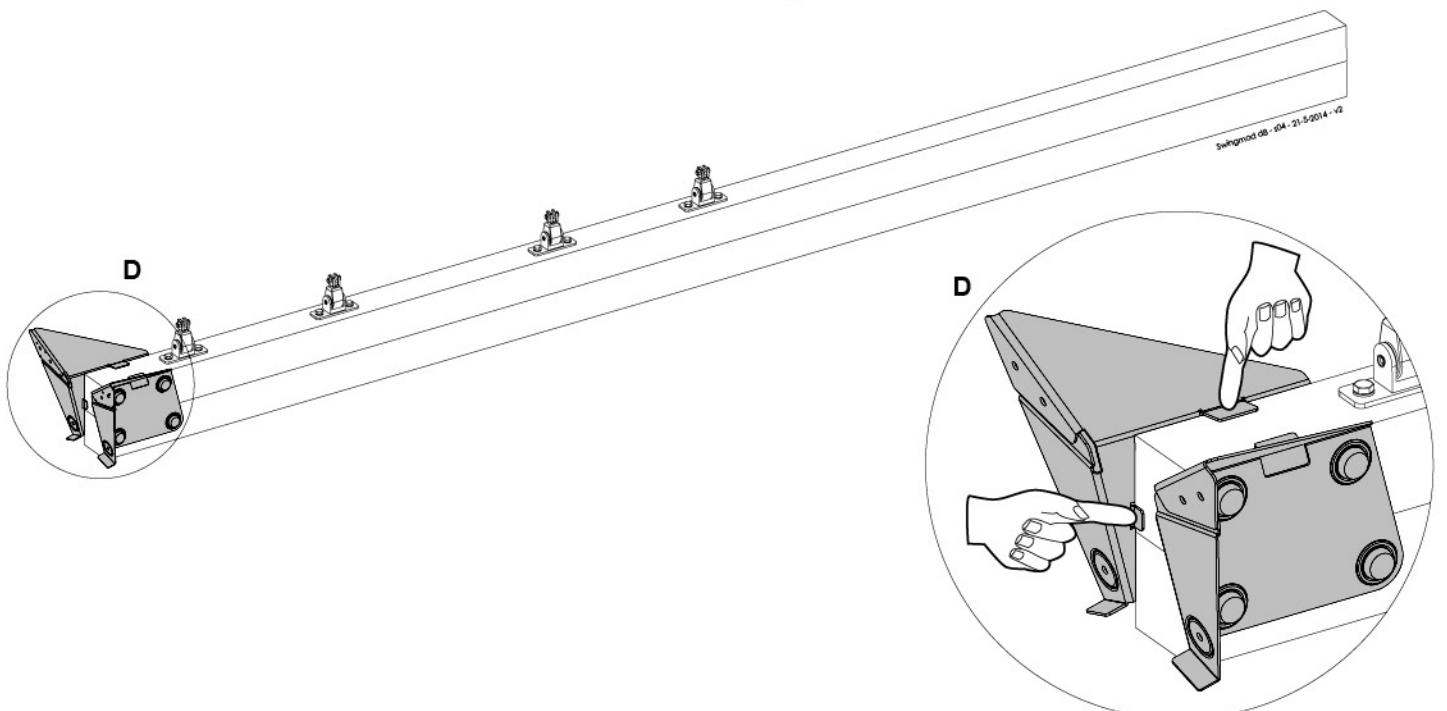
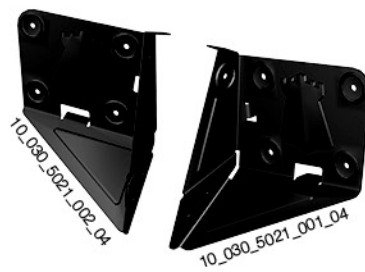

# 6.1e

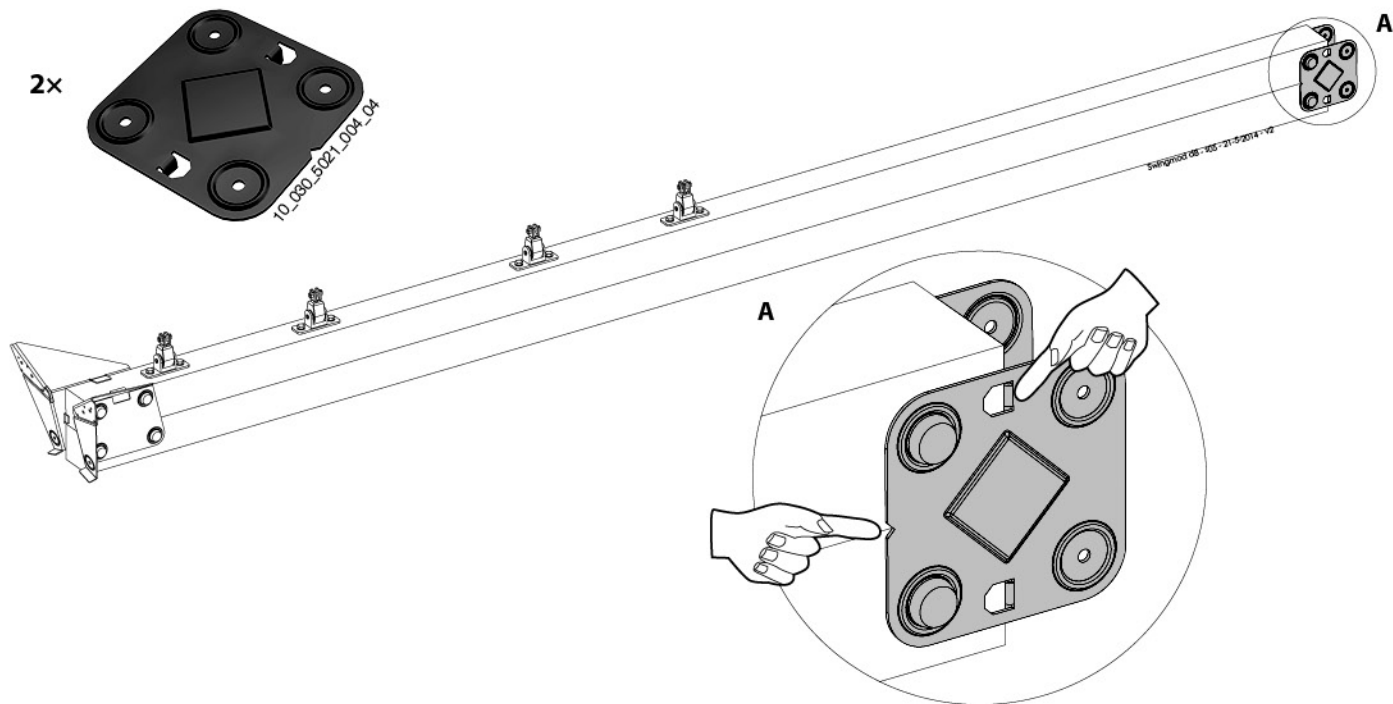
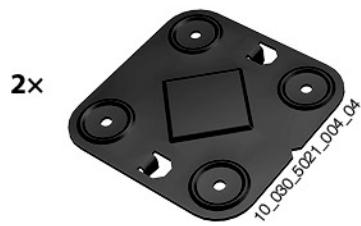
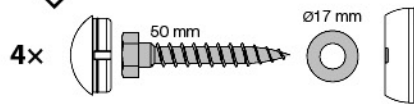

# 6.1f

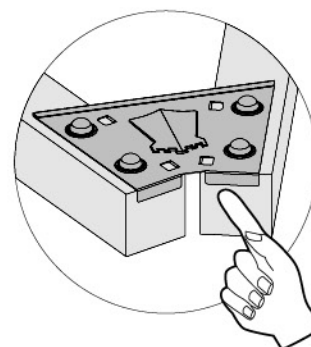
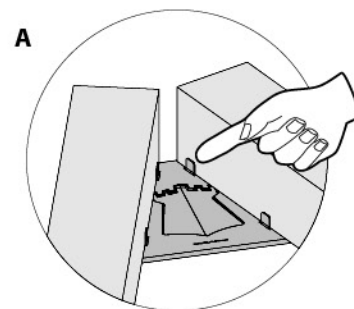
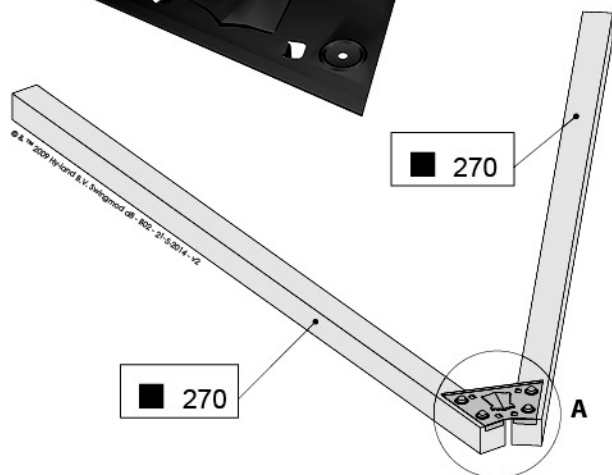
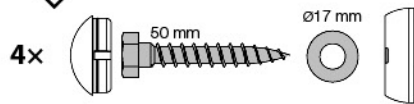



**6.1g**

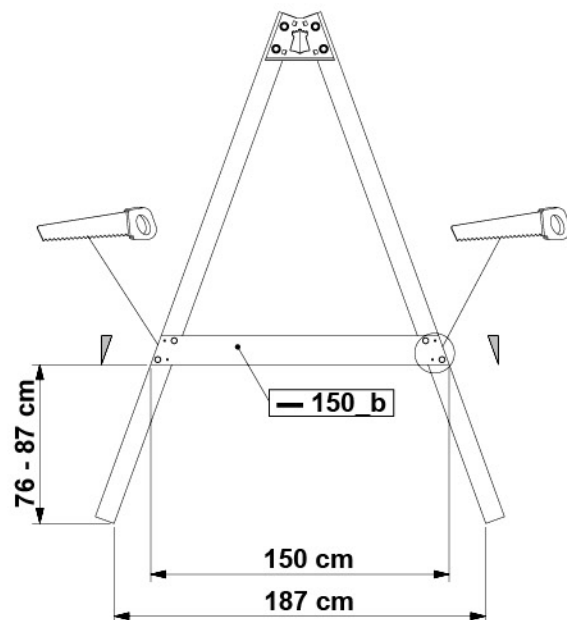
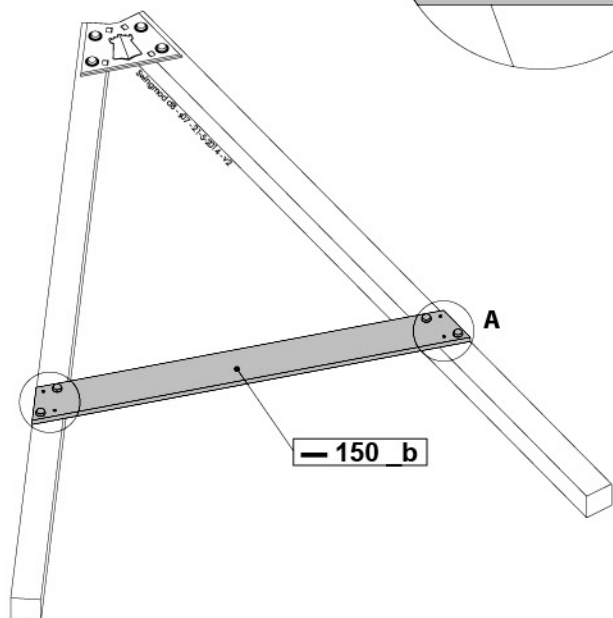
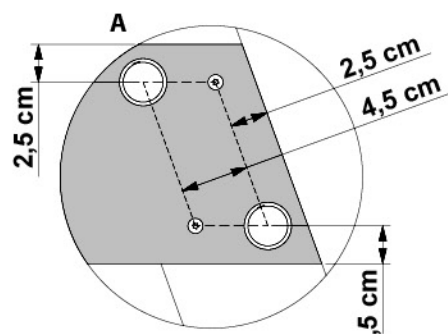
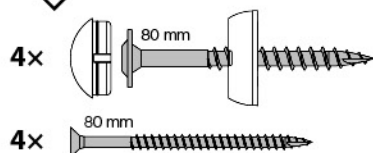

**6.1h**



10\_026\_7091\_160\_01

10\_036\_7057\_142\_01

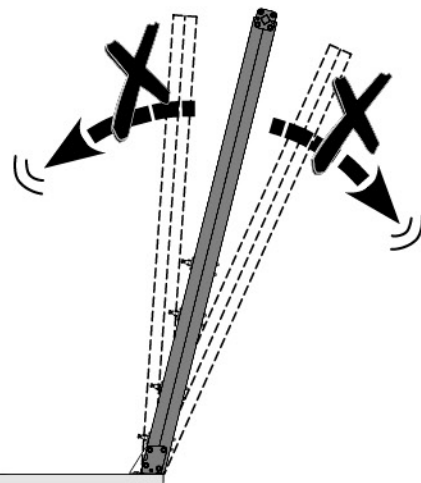
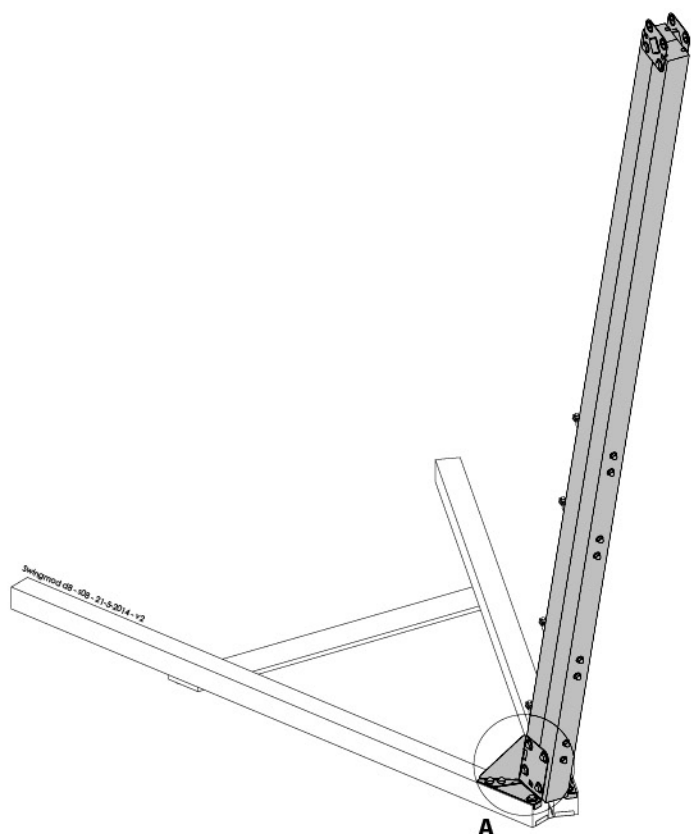
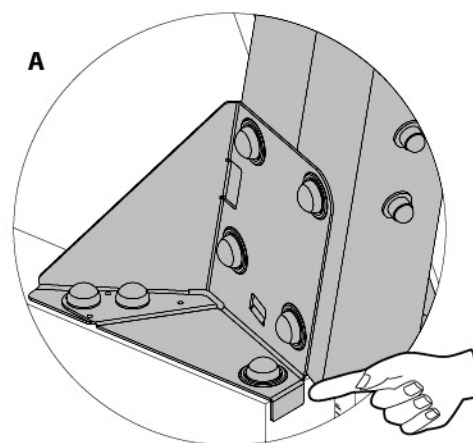

6.1i

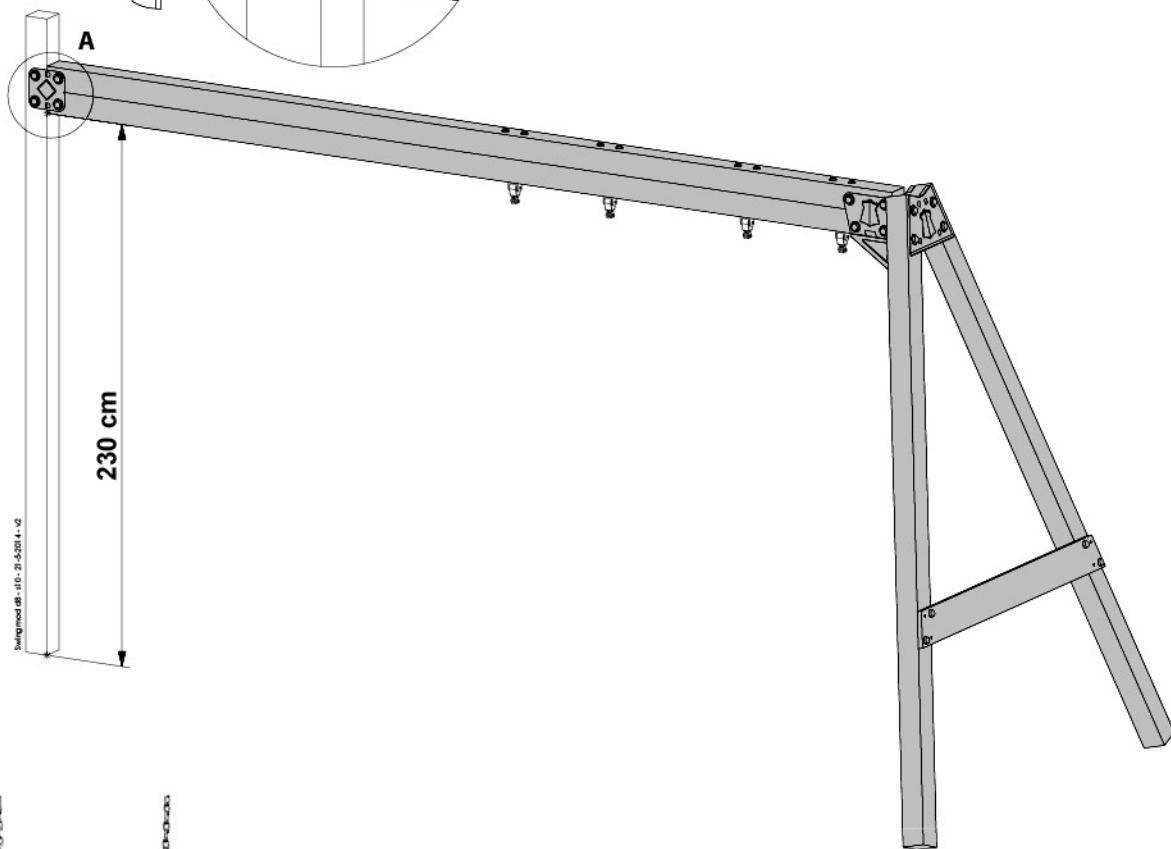
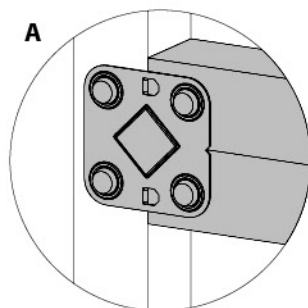
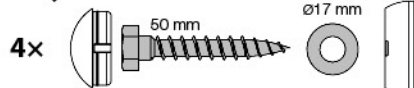

6.1j

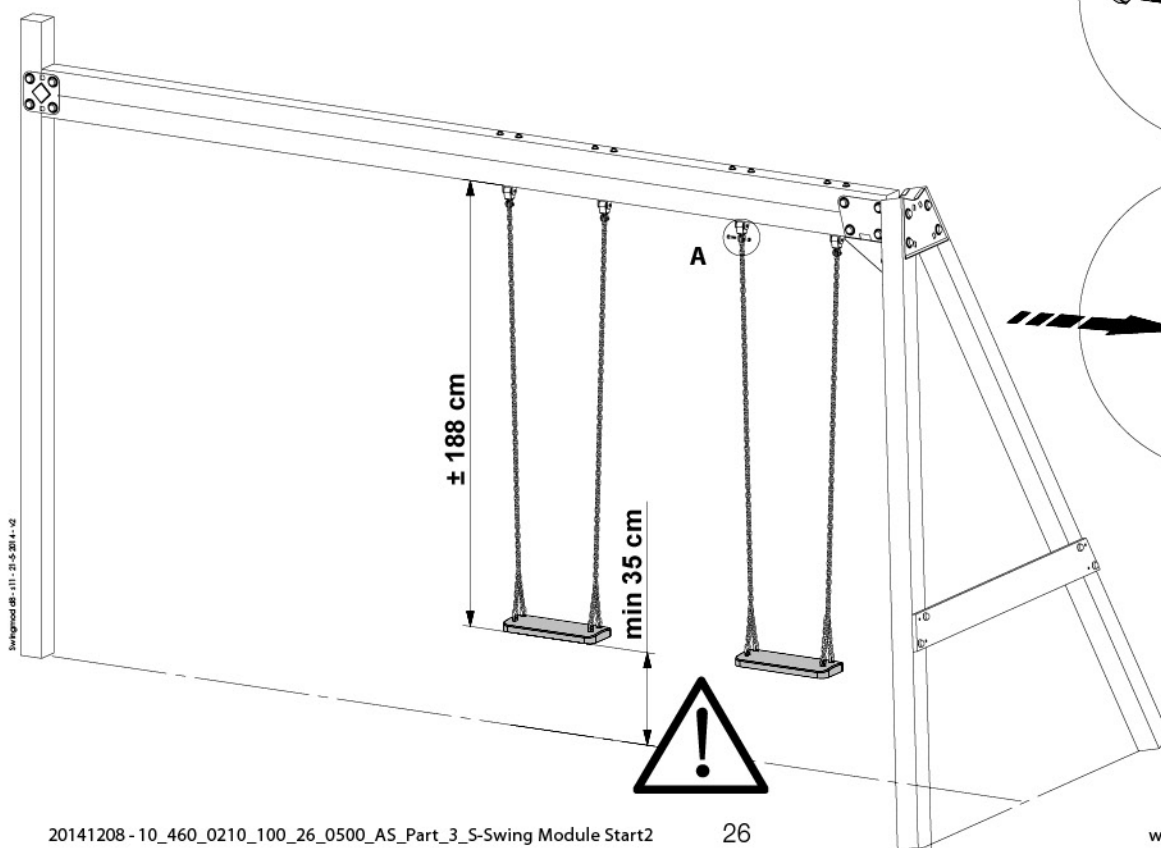
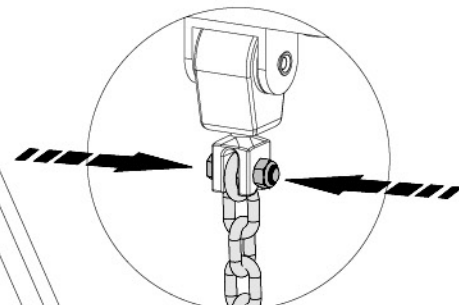
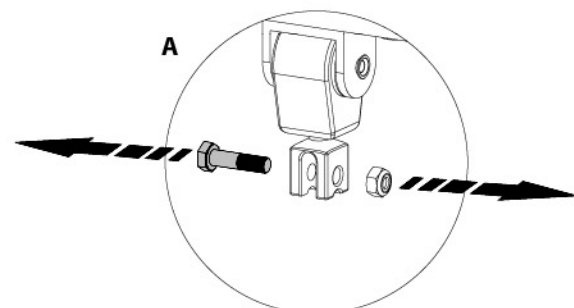

6.1k'

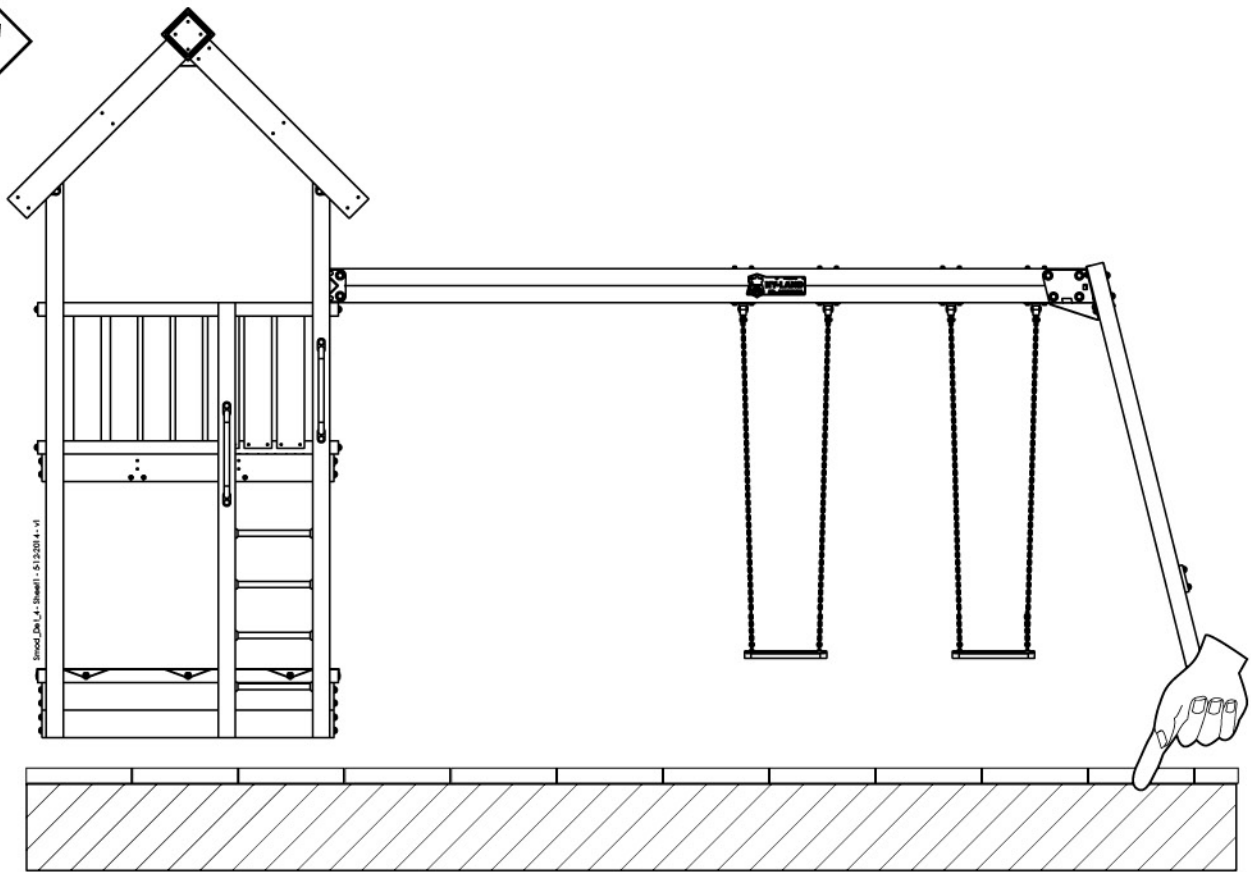

6.1k''

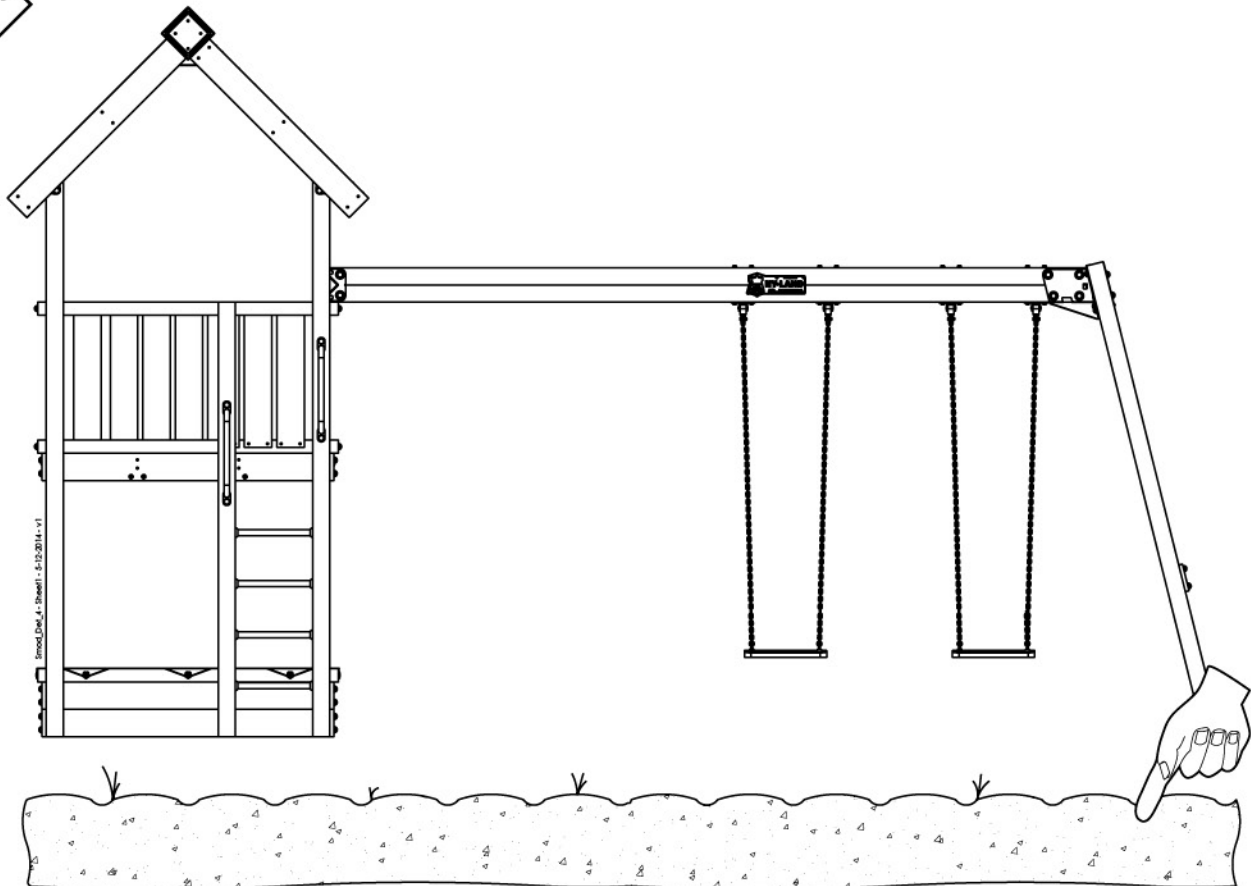

6.1k'

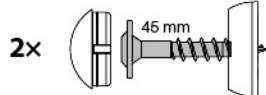

2x

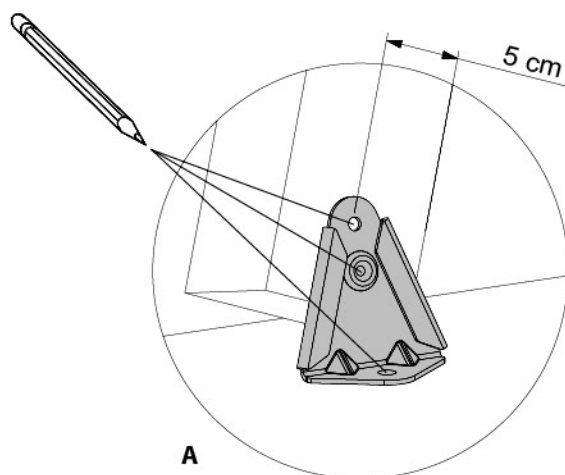
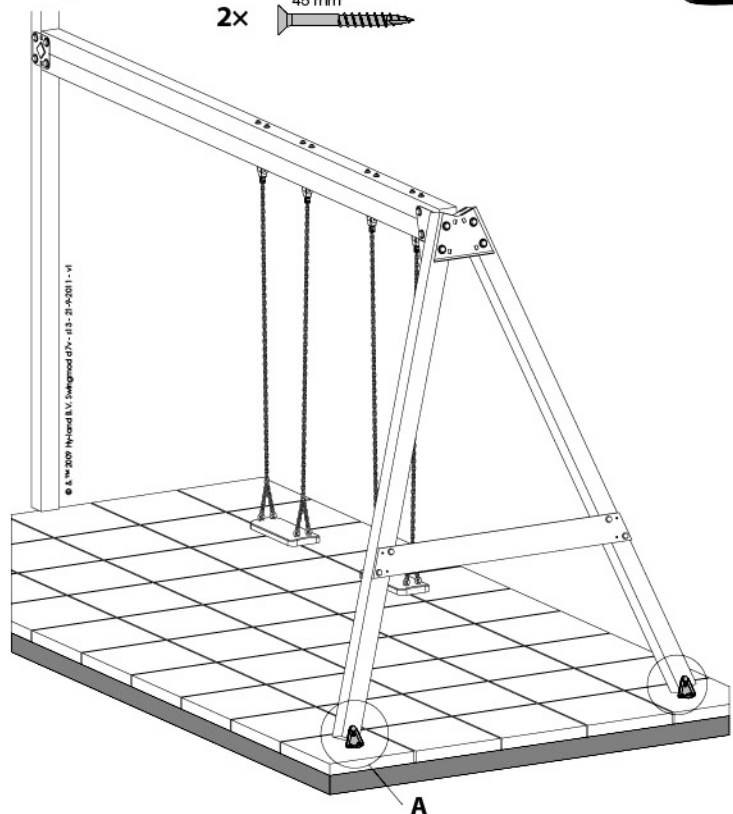

6.1k''

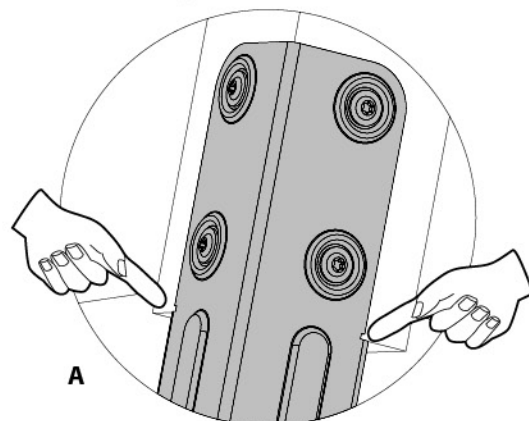
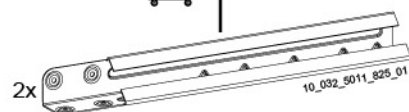
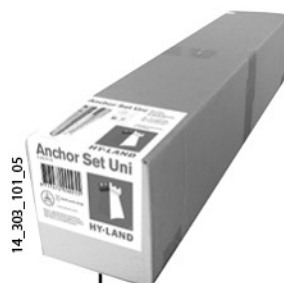
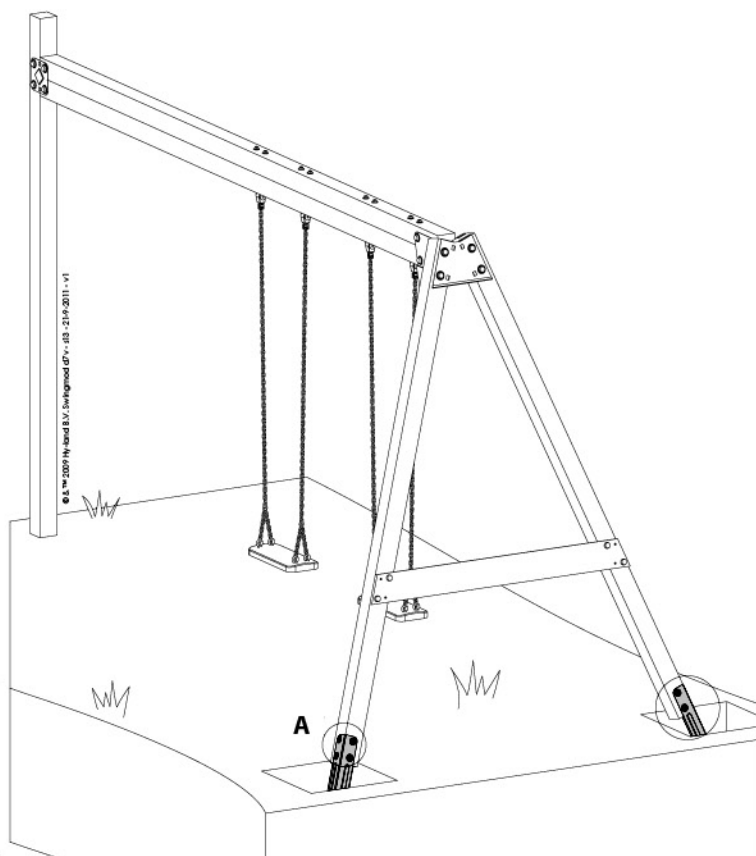

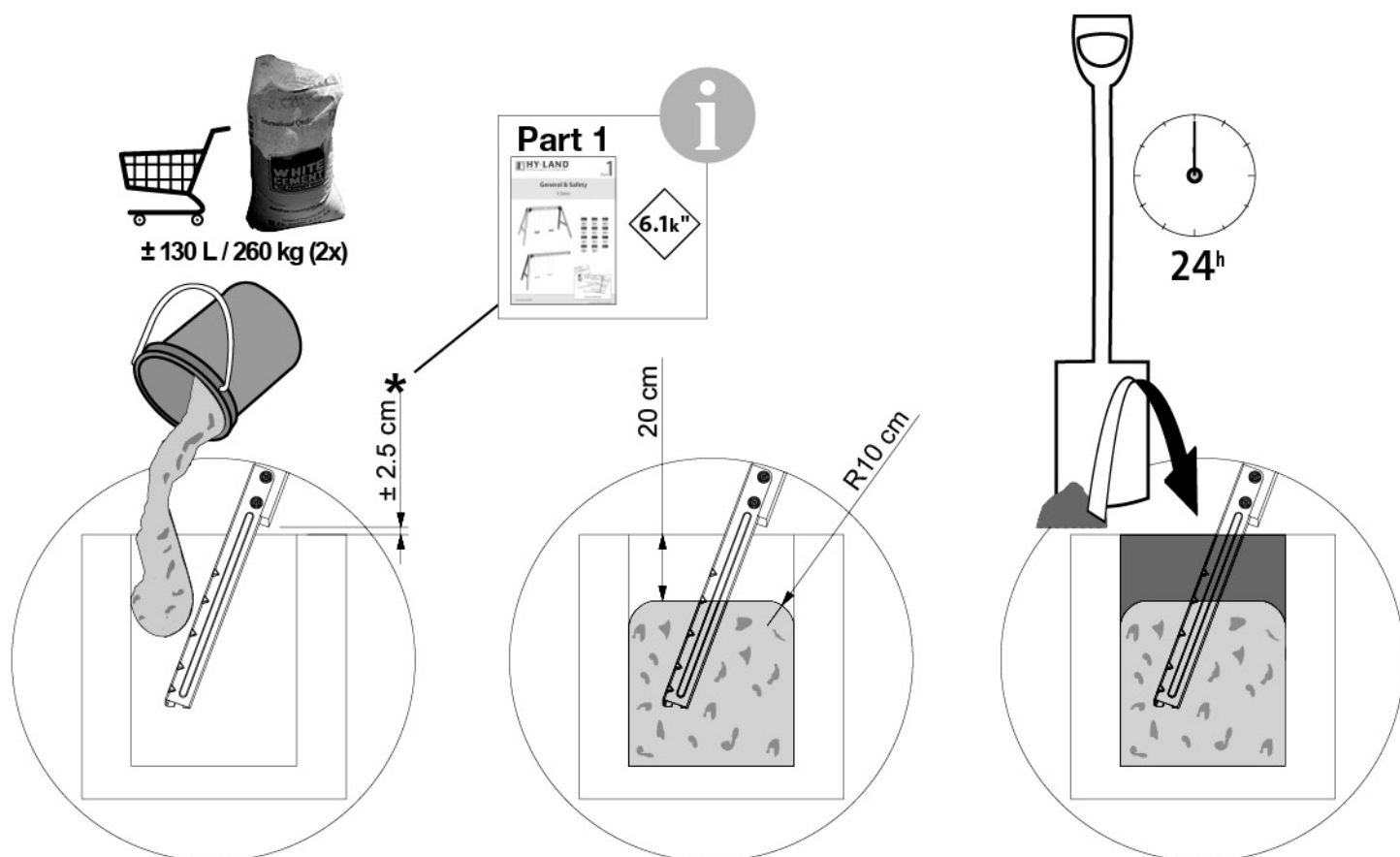
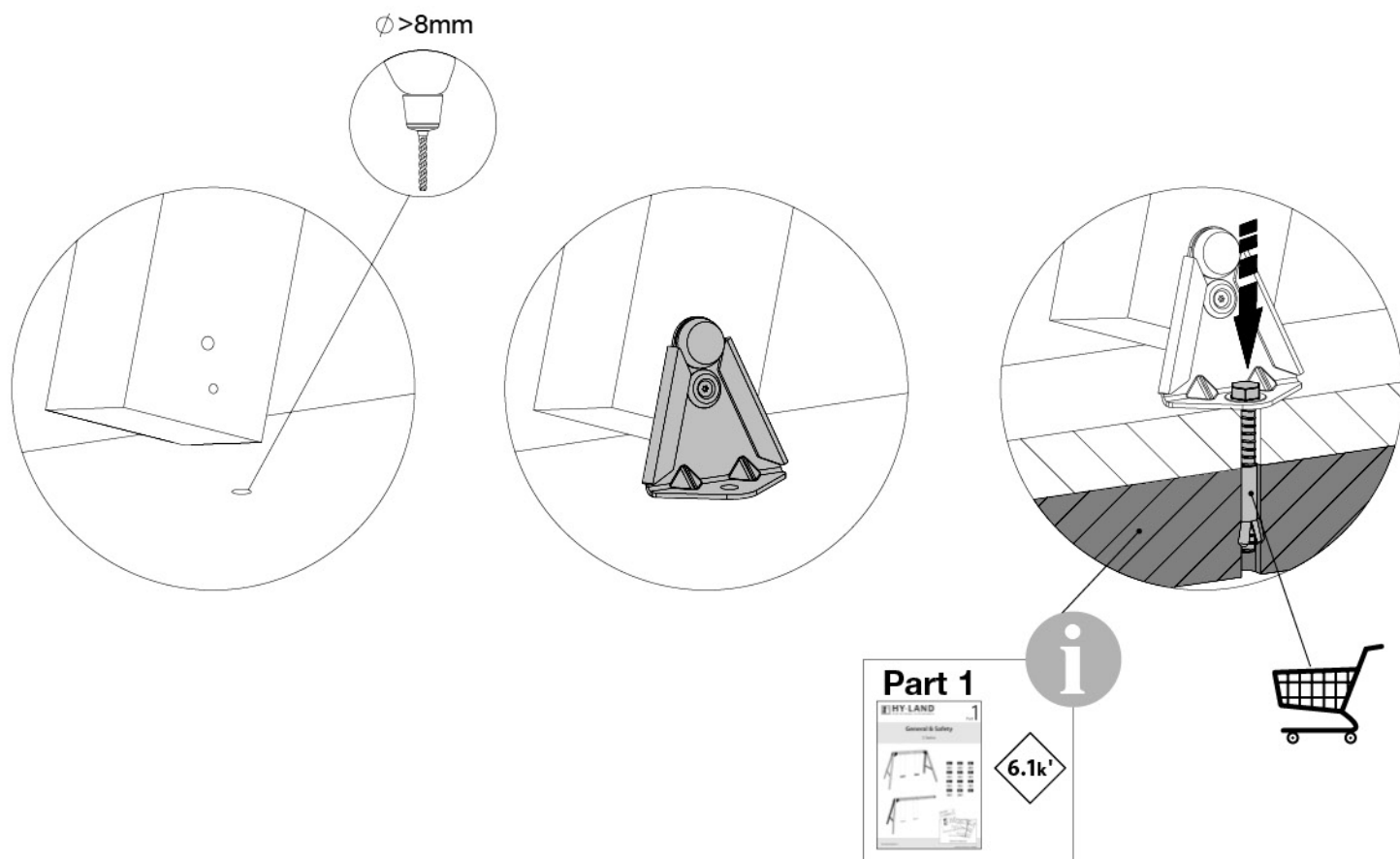

**6.1L**

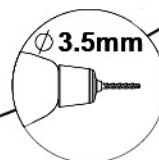
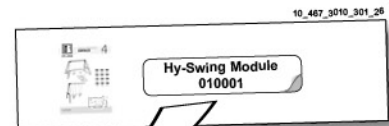

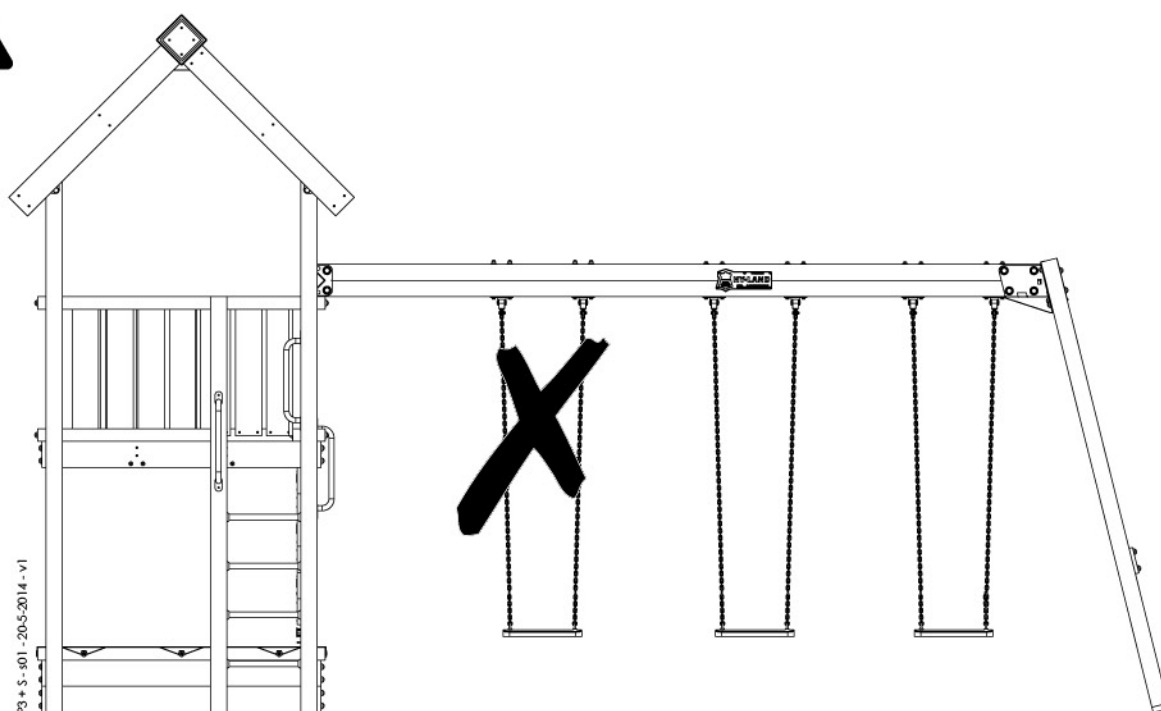
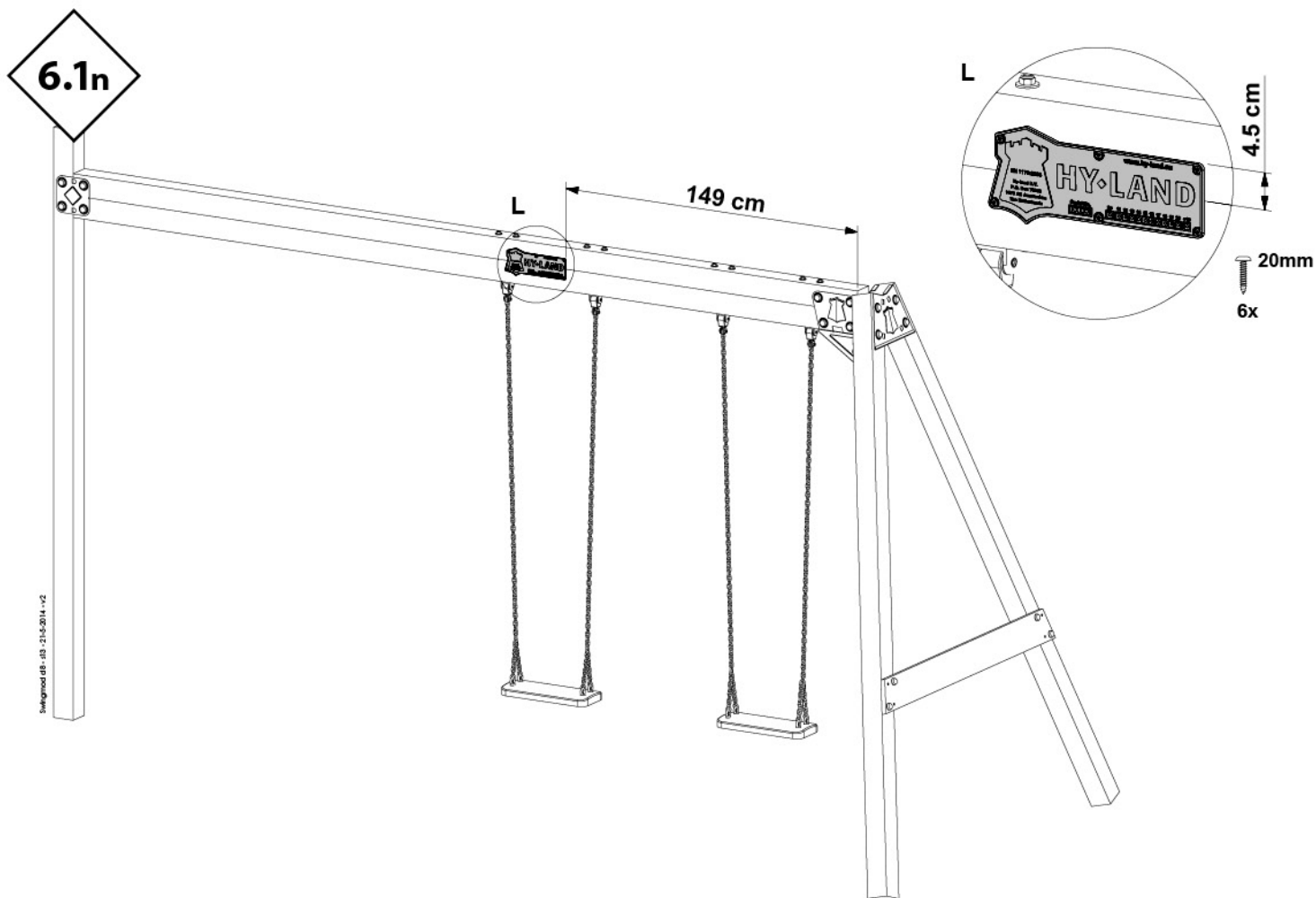

Hy-land B.V.  
Valschermkade 18  
NL - 1059 CD Amsterdam  
The Netherlands

Tel : +31 85 444 41 01  
Email : [info@hy-land.eu](mailto:info@hy-land.eu)  
URL : [www.hy-land.eu](http://www.hy-land.eu)

Chamber of Commerce :  
NL 16.078.319

